

24081  
**AIRPORT DIAGRAM**

AL-5089 (FAA)

**FREDERICK MUNI (F'DK)**  
FREDERICK, MARYLAND

NE-3, 21 MAR 2024 to 18 APR 2024

NE-3, 21 MAR 2024 to 18 APR 2024

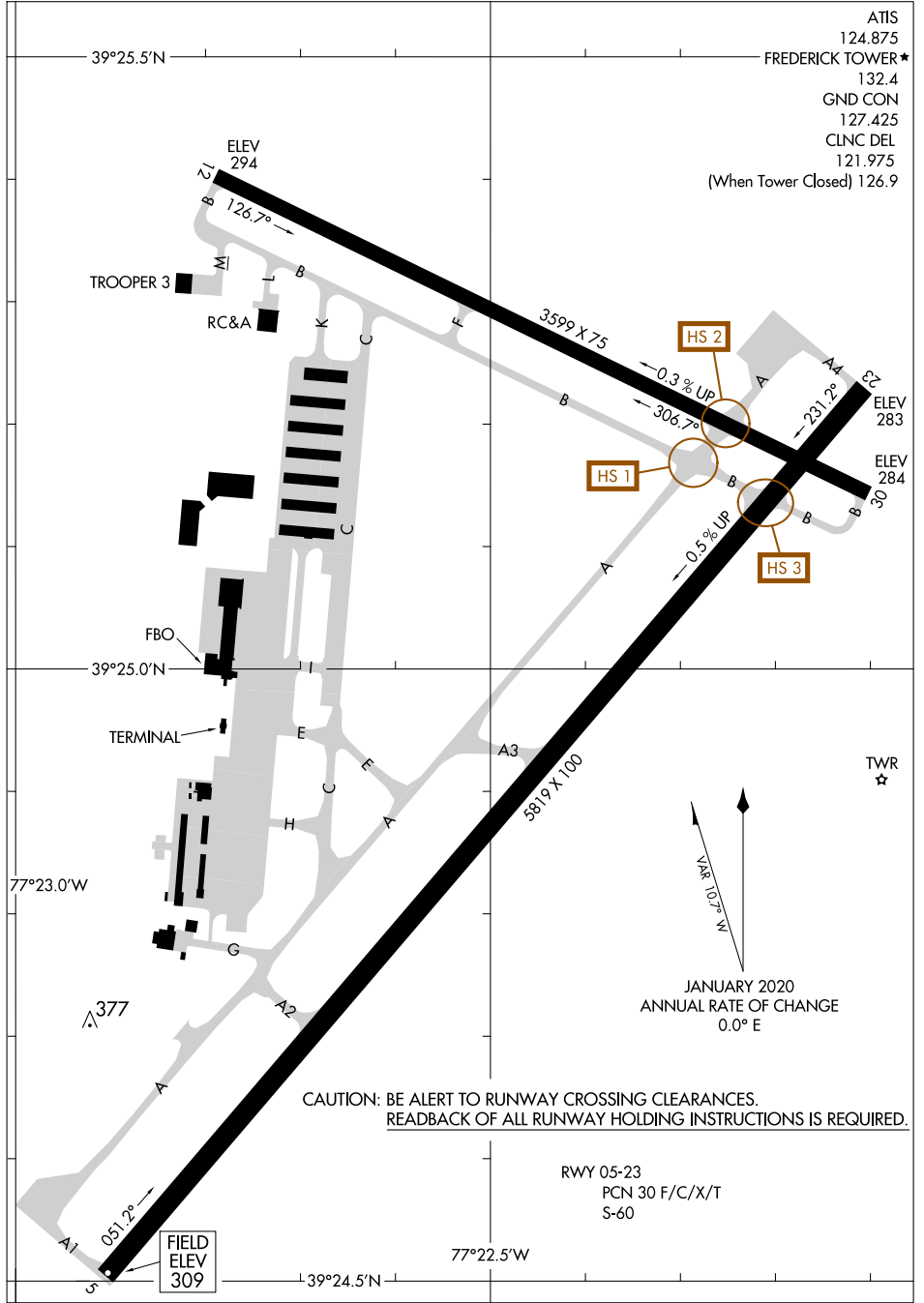

**CAUTION: BE ALERT TO RUNWAY CROSSING CLEARANCES.  
RECALL OF ALL RUNWAY HOLDING INSTRUCTIONS IS REQUIRED.**

RWY 05-23  
PCN 30 F/C/X/T  
S-60

24081  
**AIRPORT DIAGRAM**

FREDERICK, MARYLAND  
**FREDERICK MUNI (F'DK)**