

23110 **AIRPORT DIAGRAM** WASHINGTON DULLES INTL (IAD) WASHINGTON, DC

AL-5100 (FAA)

D-ATIS
 134.85
 DULLES TOWER
 120.1 317.8 (RWY 01R-19L)
 120.25 348.6 (RWY 01C-19C)
 134.425 348.6
 (RWYS 01L-19R, 12-30)
 GND CON
 121.9 317.8 (EAST)
 121.625 348.6 (WEST)
 CLNC DEL
 135.7 317.8
 MIDFIELD RAMP CON
 129.55
 CPDLC
 PDC

D
 ASDE-X in use. Operate transponders with altitude reporting mode and ADS-B (if equipped) enabled on all airport surfaces.

Runway Status Lights in operation.

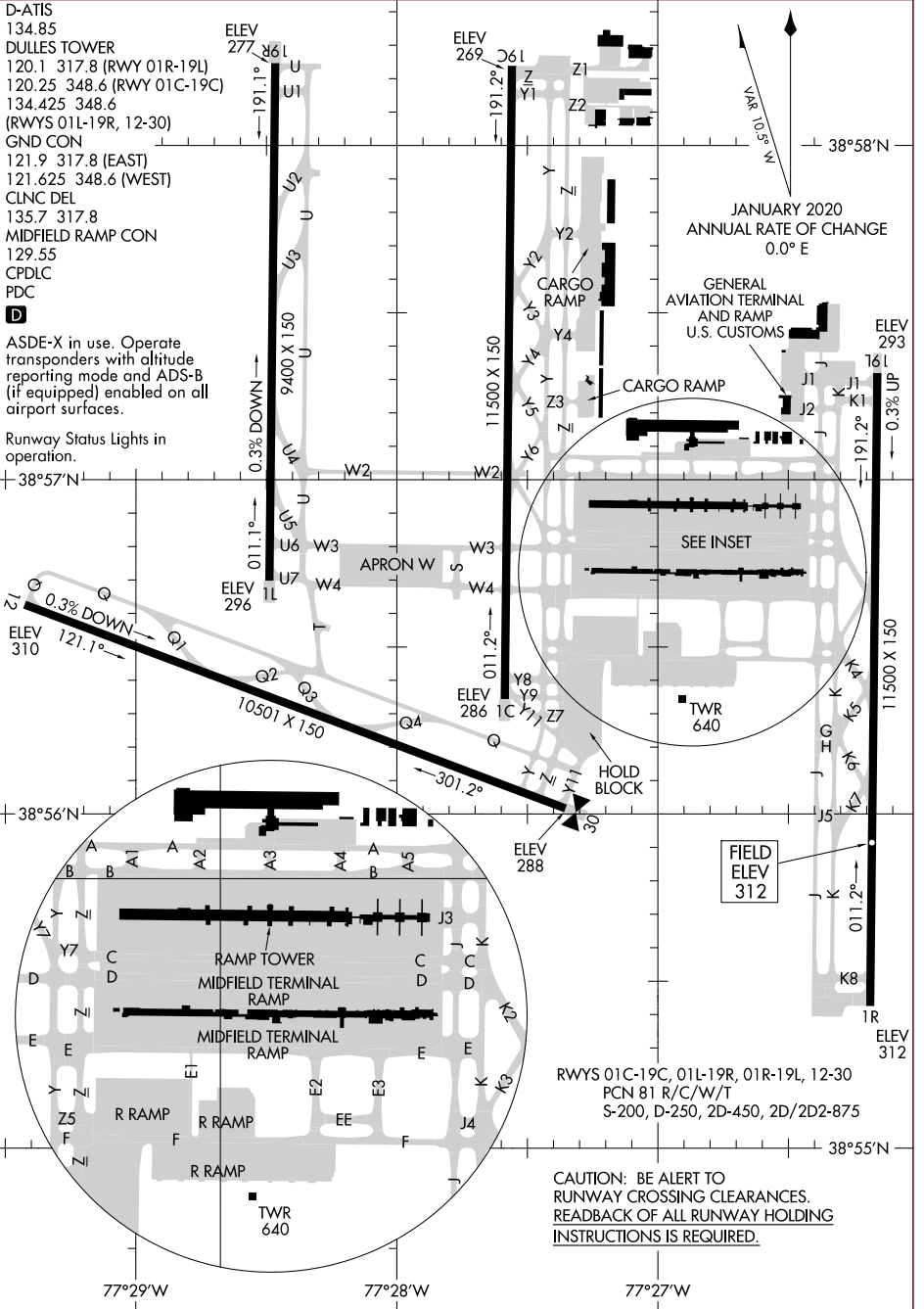

JANUARY 2020 ANNUAL RATE OF CHANGE 0.0° E

NE-3, 18 MAY 2023 to 15 JUN 2023

NE-3, 18 MAY 2023 to 15 JUN 2023