

AL-379 (FAA)

SANTA MARIA, CALIFORNIA

ATIS  
121.15  
SANTA MARIA TOWER \*  
118.3 239.25  
GND CON  
121.9  
**D**

JANUARY 2020  
ANNUAL RATE OF CHANGE  
0.1° W



SW-3, 16 JUN 2022 to 14 JUL 2022

SW-3, 16 JUN 2022 to 14 JUL 2022

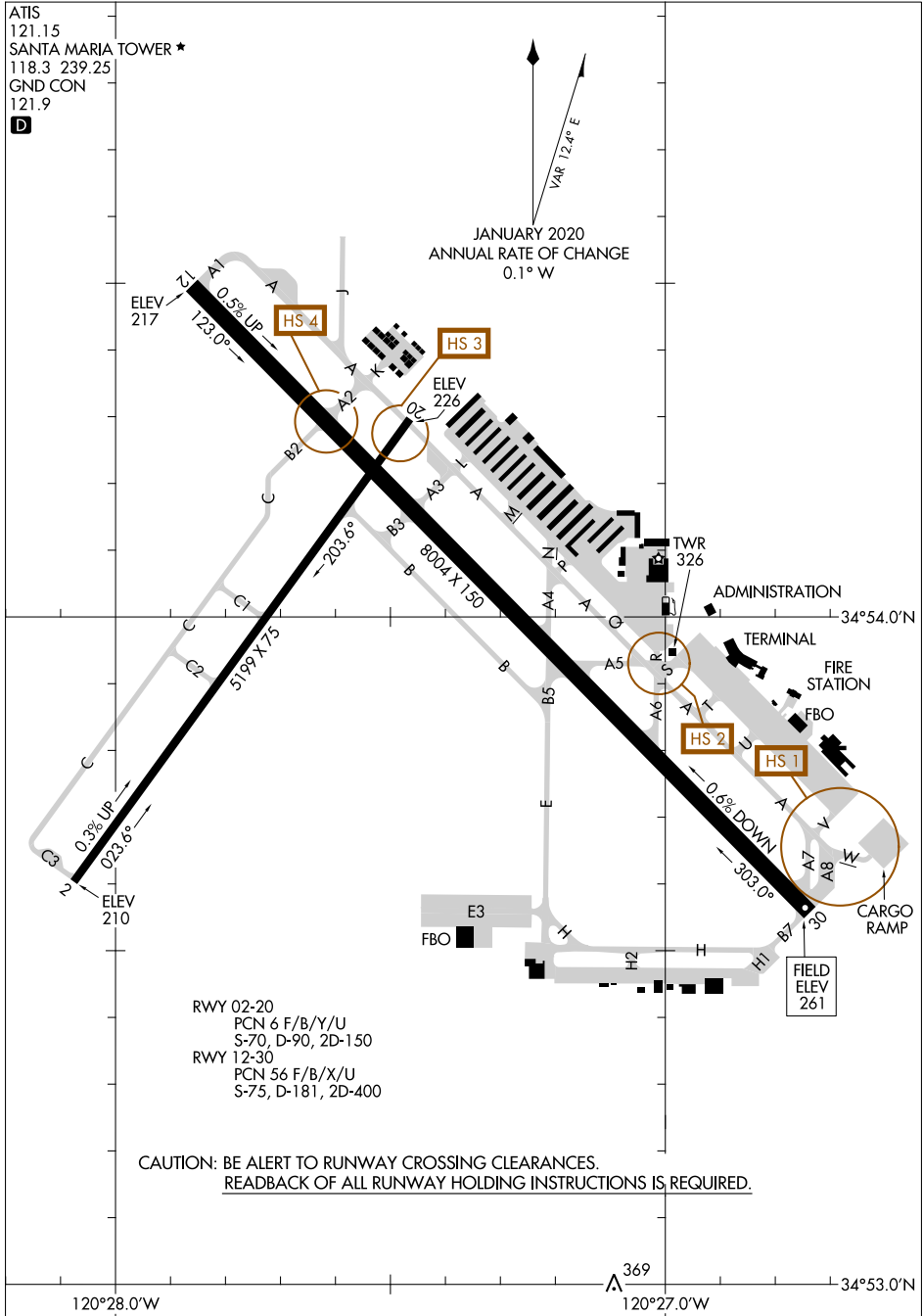

RWY 02-20  
PCN 6 F/B/Y/U  
S-70, D-90, 2D-150  
RWY 12-30  
PCN 56 F/B/X/U  
S-75, D-181, 2D-400

CAUTION: BE ALERT TO RUNWAY CROSSING CLEARANCES.  
REDBACK OF ALL RUNWAY HOLDING INSTRUCTIONS IS REQUIRED.