

AIRPORT DIAGRAM

AL-162 (FAA)

FRESNO YOSEMITE INTL (FAT)
FRESNO, CALIFORNIA

SW-2, 11 OCT 2018 to 08 NOV 2018

SW-2, 11 OCT 2018 to 08 NOV 2018

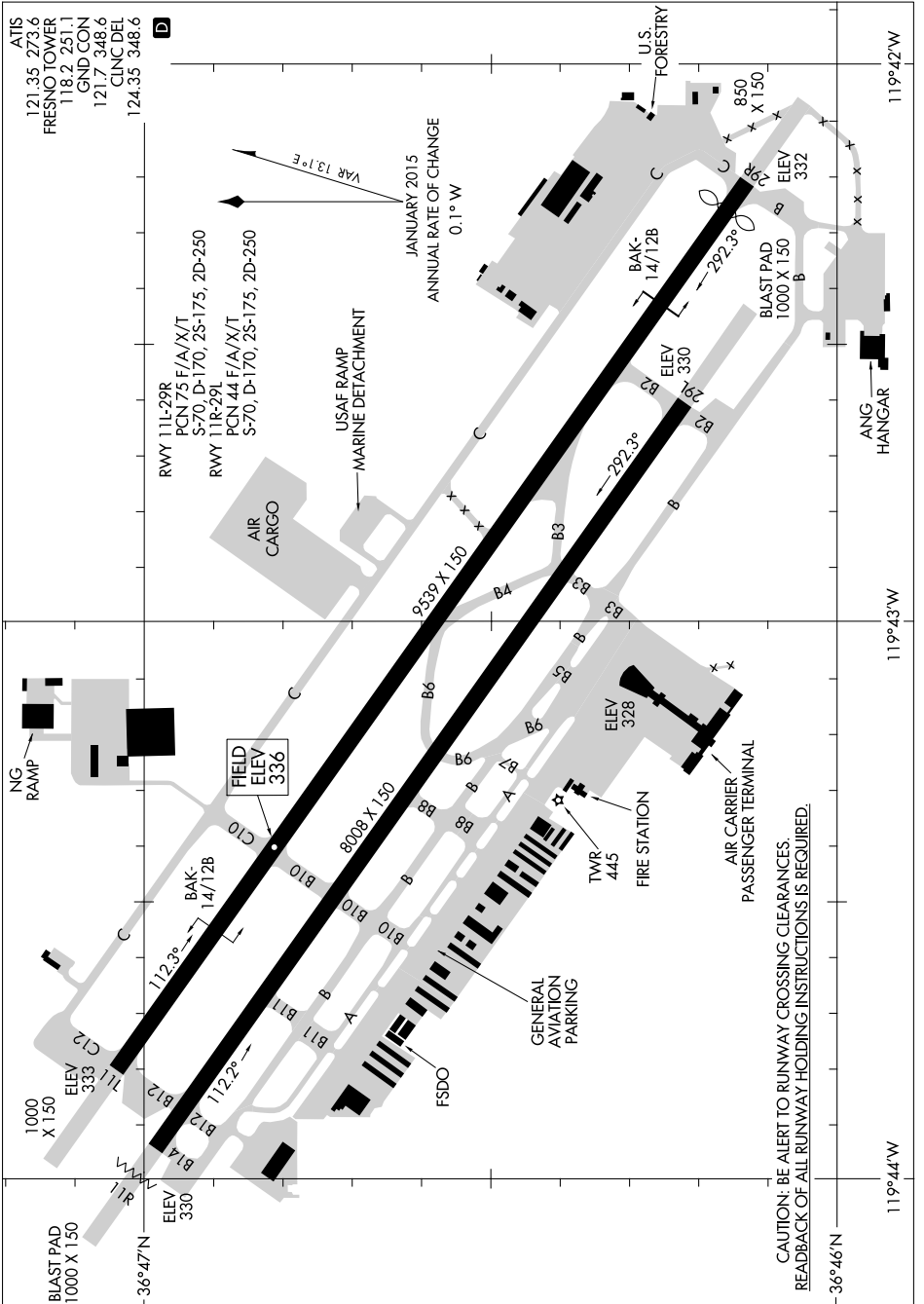

AIRPORT DIAGRAM

FRESNO, CALIFORNIA
FRESNO YOSEMITE INTL (FAT)

ATIS
121.35 273.6
FRESNO TOWER
118.2 251.1
GND CON
121.7 348.6
CLNC DEL
124.35 348.6

D

RWY 11L-29R
PCN 75 F/A/X/T
S-70, D-170, 2S-175, 2D-250
RWY 11R-29L
PCN 44 F/A/X/T
S-70, D-170, 2S-175, 2D-250

USAF RAMP
MARINE DETACHMENT

AIR CARGO

NG RAMP

FIELD ELEV 336

BLAST PAD
1000 X 150

ELEV 330

FSDO

GENERAL AVIATION PARKING

TWR 445

FIRE STATION

AIR CARRIER PASSENGER TERMINAL

CAUTION: BE ALERT TO RUNWAY CROSSING CLEARANCES
READBACK OF ALL RUNWAY HOLDING INSTRUCTIONS IS REQUIRED.

JANUARY 2015
ANNUAL RATE OF CHANGE
0.1° W

VAR 131°E

U.S. FORESTRY

BAK-14/12B

850 X 150

ELEV 332

BLAST PAD
1000 X 150

ANG HANGAR

36°47'N

112.2°W

112.3°W

112.3°W

119°44'W

119°43'W

119°42'W