

Flight Procedures Cover Page	Task Action: FLIGHT CHECK	Task Type: Textual DP	Estimated Chart Date: 12/28/2023	APWS Task ID: 648F458E8D834D11A170A4C04877F62D	APWS Project ID: 4840F98553474ECF86B8451BC0B131A3
Procedure: TAKEOFF MINIMUMS ODP ORIG-A		Enroute: YES	Specialist: Verma, Neeraj		Agreement Number:
Airport ID: KLYV			Airport City: LUVERNE		State: MN
Facility ID:	Facility Type:	Flight Inspection Remark Type: New FC Slot			
<div>Procedure Comments: THIS CANCELS FDC 2/3631.  ACTIVE AIRPORT AND RUNWAY DATA USED.  CONTACT RAKE MCGRAW: 405-954-8711</div> <div>QUALITY 20 CHECKED</div>					

<b>FIPC BASIC FORM</b>						
<b>PROCEDURE:</b> TAKEOFF MINIMUMS AND OBSTACLE DP AMDT 0A			<b>AIRPORT NAME:</b> QUENTIN AANENSON FLD		<b>AIRPORT ID:</b> KLYV	<b>SPECIAL CONTROL NO:</b> BP-08-279-23
<b>FAC ID:</b> KLYV		<b>CITY:</b> LUVERNE			<b>ST:</b> MN	<b>ORIG CHART DATE:</b> 11/30/2023
<b>DFL TYPE:</b> PROC/T	<b>THIRD PARTY:</b> <input type="checkbox"/> YES	<b>EST. TIME ON SITE:</b> 0.4	<b>REIMB. NUMBER:</b>	<b>PTS TASK ID:</b> 648F458E8D834D11A170A4C04877F62D		
<b>PREFLIGHT NOTES</b>						
<b>REVIEWER:</b> matthew olstad					<b>DATE:</b> 11/10/2023	
<b>COMMENTS:</b>					<b>CHECK ONE:</b>	
					<input checked="" type="checkbox"/> FLT CK REQ <input type="checkbox"/> NFCR <input type="checkbox"/> REJECT	
						<b>YES</b>
					<b>CPV COMPLETE?</b>	<b>X</b>
<b>PROCEDURE RESULTS</b>						
<b>INSPECTION DATE:</b> 11/09/2023	<b>CREW #:</b> VN427	<b>N #:</b> N90	<b>INSTRUMENT PROCEDURE STATUS:</b> <input checked="" type="checkbox"/> SAT <input type="checkbox"/> SAT W/CHANGES <input type="checkbox"/> UNSAT		<b>ARINC CODING:</b> <input checked="" type="checkbox"/> SAT <input type="checkbox"/> SAT/GOLD <input type="checkbox"/> UNSAT	
<b>FLIGHT INSPECTOR SIGNATURE:</b> matthew olstad @ 11/09/2023 21:31			<b>PRINTED NAME:</b> OLSTAD, MATTHEW WILLIAM			<b>NOTAM INITIATED?</b> <input type="checkbox"/> YES <input checked="" type="checkbox"/> NO
<b>FLIGHT INSPECTOR REMARKS:</b>						
<b>IN-FLIGHT OBSTACLE REPORT</b>						
<b>OBSTRUCTION ID #:</b>	<b>COORDINATES OR LOCATION:</b>	<b>GNSS ALTITUDE (MSL):</b>	<b>BAROMETRIC ALTITUDE (MSL):</b>	<b>HEIGHT ABOVE GROUND LEVEL:</b>		

# TAKEOFF MINIMUMS, (OBSTACLE) DEPARTURE PROCEDURES, AND DIVERSE VECTOR AREA (RADAR VECTORS)

## LONGVILLE, MN (CON'T)

### LONGVILLE MUNI (XVG) (CON'T)

**Rwy 31 (CON'T)**, trees, vehicles on road beginning 288' from DER, 131' right of centerline, up to 24' AGL/1359' MSL.

Trees, vehicles on road beginning 362' from DER, 4' left of centerline, up to 1414' MSL.

Tree 368' from DER, 524' right of centerline, 48' AGL/1383' MSL.

Trees beginning 370' from DER, 216' right of centerline, up to 1406' MSL.

Trees, vehicles on road beginning 505' from DER, 18' right of centerline, up to 1408' MSL.

Trees, vehicles on road beginning 666' from DER, 80' right of centerline, up to 1412' MSL.

Tree 758' from DER, 457' right of centerline, 1414' MSL.

Trees, vehicles on road, buildings beginning 780' from DER, 4' right of centerline, up to 83' AGL/1426' MSL.

Trees beginning 1456' from DER, 2' left of centerline, up to 76' AGL/1415' MSL.

Trees beginning 1545' from DER, 110' left of centerline, up to 65' AGL/1416' MSL.

Trees beginning 1564' from DER, 180' left of centerline, up to 64' AGL/1418' MSL.

Trees beginning 1575' from DER, 105' left of centerline, up to 70' AGL/1425' MSL.

Trees beginning 1589' from DER, 92' left of centerline, up to 69' AGL/1426' MSL.

Trees beginning 1640' from DER, 101' left of centerline, up to 1430' MSL.

Trees beginning 1667' from DER, 19' left of centerline, up to 1432' MSL.

Trees beginning 1748' from DER, 4' right of centerline, up to 80' AGL/1431' MSL.

Trees beginning 1792' from DER, 50' left of centerline, up to 86' AGL/1434' MSL.

Trees beginning 1808' from DER, 3' left of centerline, up to 1435' MSL.

Trees beginning 1894' from DER, 15' left of centerline, up to 1441' MSL.

Trees beginning 1915' from DER, 1' left of centerline, up to 1442' MSL.

Trees beginning 1974' from DER, 0' left of centerline, up to 1446' MSL.

Trees, pole beginning 1994' from DER, 49' right of centerline, up to 82' AGL/1434' MSL.

Trees beginning 2009' from DER, 3' left of centerline, up to 1448' MSL.

Trees beginning 2016' from DER, 1' right of centerline, up to 92' AGL/1442' MSL.

Trees beginning 2058' from DER, 5' left of centerline, up to 1449' MSL.

Trees beginning 2104' from DER, 51' left of centerline, up to 1454' MSL.

Trees beginning 2110' from DER, 32' left of centerline, up to 1456' MSL.

Trees beginning 2165' from DER, 3' left of centerline, up to 1467' MSL.

Trees beginning 2910' from DER, 211' right of centerline, up to 1445' MSL.

Trees beginning 3288' from DER, 101' right of centerline, up to 83' AGL/1448' MSL.

Trees beginning 4165' from DER, 62' right of centerline, up to 1449' MSL.

Trees beginning 4203' from DER, 115' right of centerline, up to 1456' MSL.

Tree 4245' from DER, 122' right of centerline, 1459' MSL.

Trees beginning 4250' from DER, 28' right of centerline, up to 1463' MSL.

Trees beginning 4610' from DER, 306' right of centerline, up to 1465' MSL.

Trees beginning 4623' from DER, 130' right of centerline, up to 77' AGL/1467' MSL.

Trees beginning 4736' from DER, 52' left of centerline, up to 1477' MSL.

Trees beginning 4832' from DER, 280' right of centerline, up to 1480' MSL.

## LIVERNE, MN

### QUENTIN AANENSON FLD (LYV)

#### TAKEOFF MINIMUMS AND (OBSTACLE) DEPARTURE PROCEDURES

ORIG 03JUN10 (22027) (FAA)

#### TAKEOFF OBSTACLE NOTES:

**Rwy 18**, tree 813' from DER, 578' left of centerline, 50' AGL/1469' MSL.

Road plus vehicle 685' from DER, 574' right of centerline, 15' AGL/1454' MSL.

Terrain 20' from DER, on centerline, 1429' MSL.

**Rwy 36**, transmission tower, 5752' from DER, 1036' right of centerline, 139' AGL/1581' MSL.

OLD

## MADISON, MN

### LAC QUI PARLE COUNTY (DXX)

#### TAKEOFF MINIMUMS AND (OBSTACLE) DEPARTURE PROCEDURES

ORIG 15NOV12 (12320) (FAA)

#### TAKEOFF MINIMUMS:

**Rwys 9, 27**, NA - Environmental.

**Rwy 32**, 300-1% or std. w/min. climb of 213' per NM to 1400, or alternatively, with standard takeoff minimums and a normal 200' per NM climb gradient, takeoff must occur no later than 1500' prior to DER.

#### TAKEOFF OBSTACLE NOTES:

**Rwy 14**, trees beginning 40' from DER, 463' right of centerline, up to 100' AGL/1081' MSL.

Terrain 22' from DER, 175' left of centerline, 1080' MSL.

**Rwy 32**, vehicles on roadway beginning 538' from DER, left to right of centerline, up to 15' AGL/1098' MSL.

Trees beginning 1485' from DER, 790' left of centerline, up to 100' AGL/1152' MSL.

Tower 1.2 NM from DER, 2112' right of centerline, 200' AGL/1277' MSL.



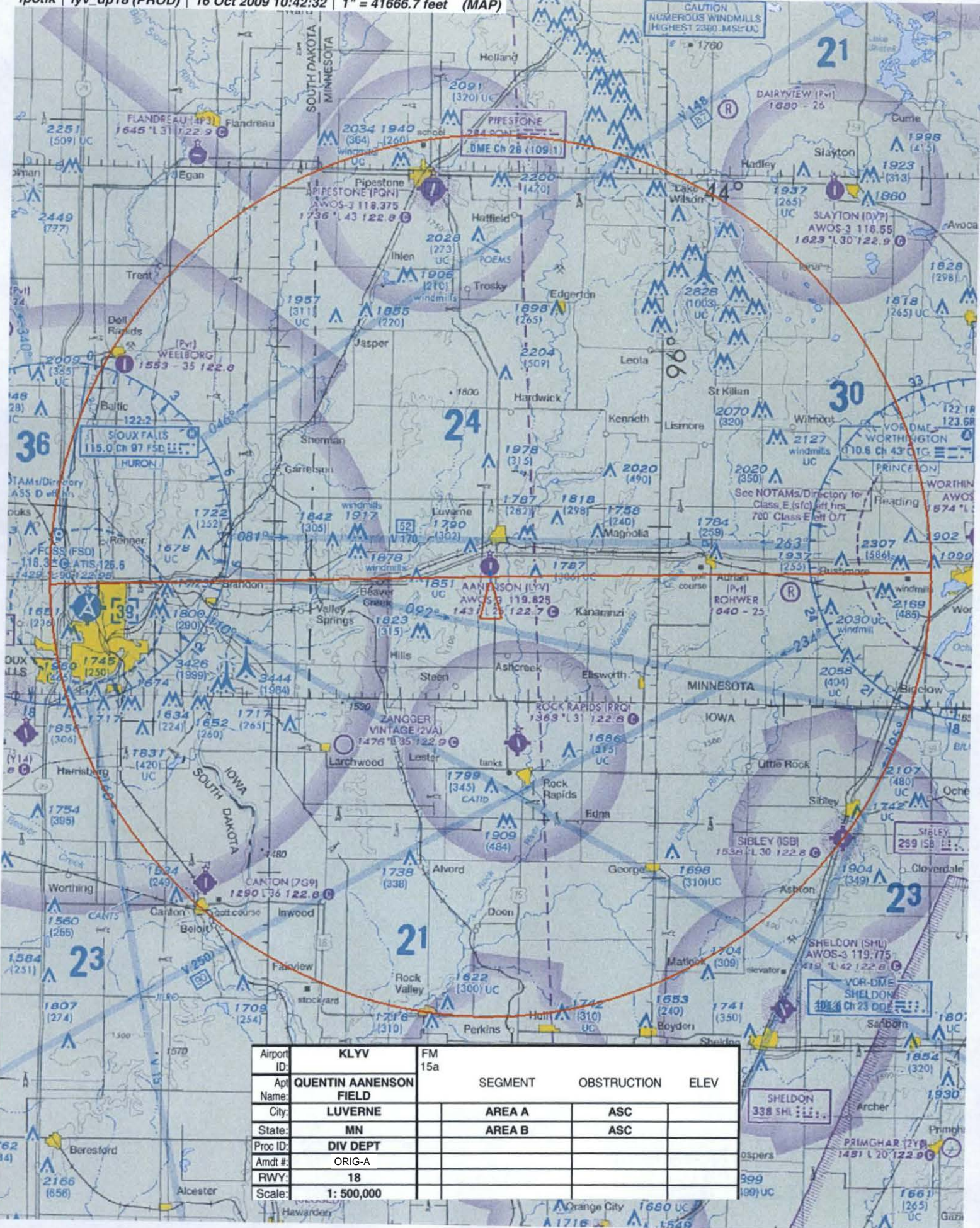



**KLYV**  
**QUENTIN AANENSON**  
**FLD**  
**LUVERNE, MN**  
**ODP AMDT ORIG-A**  
**RWY 36**  
**1:500,000**



NM 1 2 3 4 5 6 7 8 9 10  
 FT 8000 16000 24000 32000 40000 48000 56000 64000

fpotlk | lyv\_dp18 (PROD) | 16 Oct 2009 10:42:07 | 1" = 8333.3 feet (MAP)

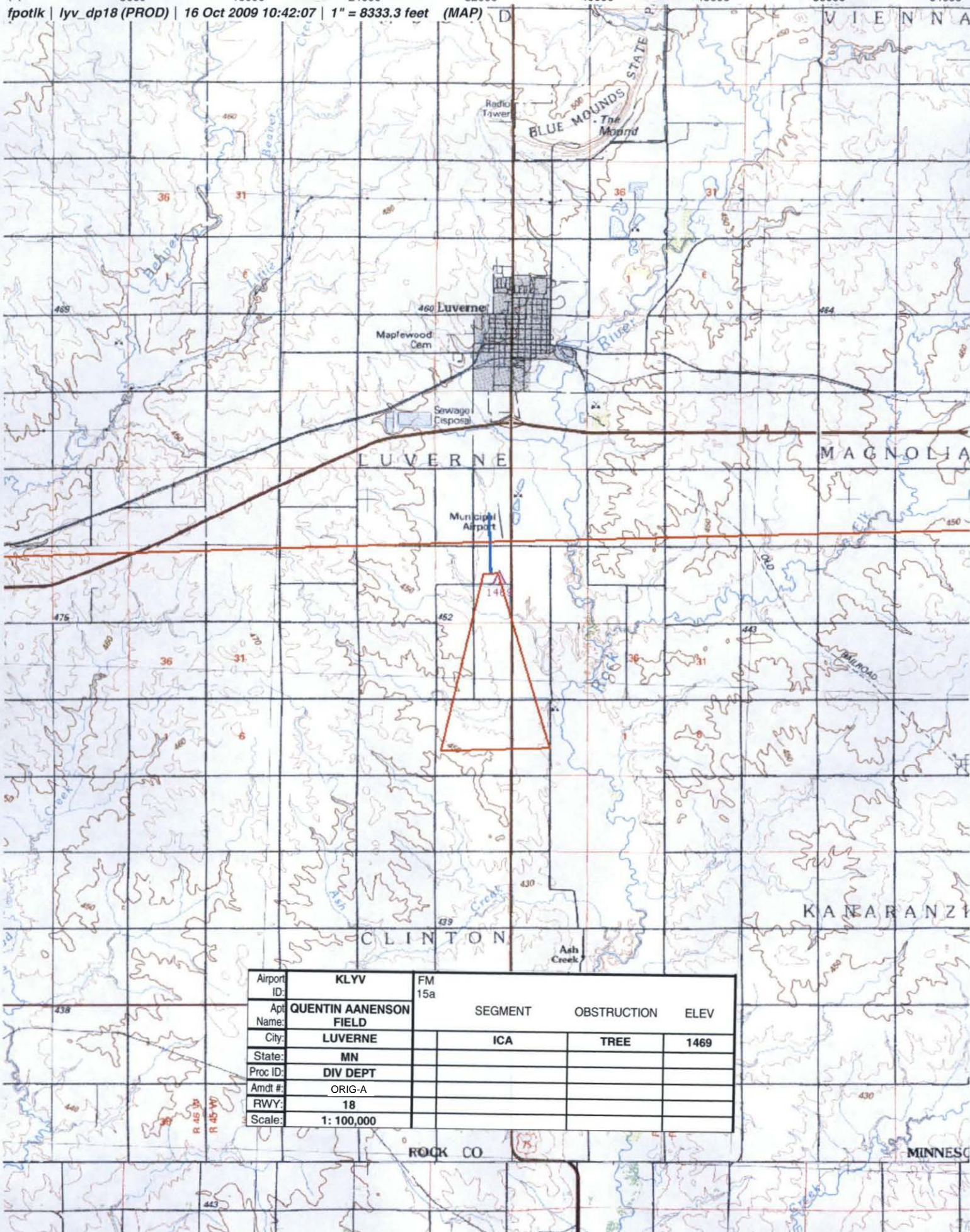

Airport ID:	KLYV	FM 15a		
Apt Name:	QUENTIN AANENSON FIELD	SEGMENT	OBSTRUCTION	ELEV
City:	LUVERNE	ICA	TREE	1469
State:	MN			
Proc ID:	DIV DEPT			
Amdt #:	ORIG-A			
RWY:	18			
Scale:	1: 100,000			

ROCK CO

MINNESOTA



KLYV  
QUENTIN AANENSON  
FLD  
LUVERNE, MN  
ODP AMDT ORIG-A  
RWY 36  
1:100,000

