

Flight Procedure Tracking Form		Action: FLIGHT CHECK	Task Type: TEXTUAL DP	Date Open: 07/03/2017	Task #: 2017070335277801001	Request #: 20170703352778
Procedure: DAVIS/WOODLAND/WINTERS CA KDWA AMDT 2			Airport ID: KDWA	Airport: YOLO COUNTY		Reimbursable #: NO
City: DAVIS/WOODLAND/WINTERS	ST: CA	GPS #:	Estimated Chart Date: 07/19/2018			FICO #:
Fac ID: N/A		Fac. Type:			Specialist: CHARLES THIBODEAUX	
Procedure Review						
	Rec'd	Rel'd	Full Name	Comments		
Lead:	07/05/2017			Digitally signed by		
QA:				19 JON DENTON		
Liaison:				Mar 16, 2018		
Procedure Comments: ENROUTE-NON Remark Type: INFORMATION ACTIVE DATA FOR KDWA AIRPORT USED. AMEND PROCEDURE TO CLEAR NOTAM FDC 7/2255. CONTACT: LONNIE EVERHART: 405.954.4576						

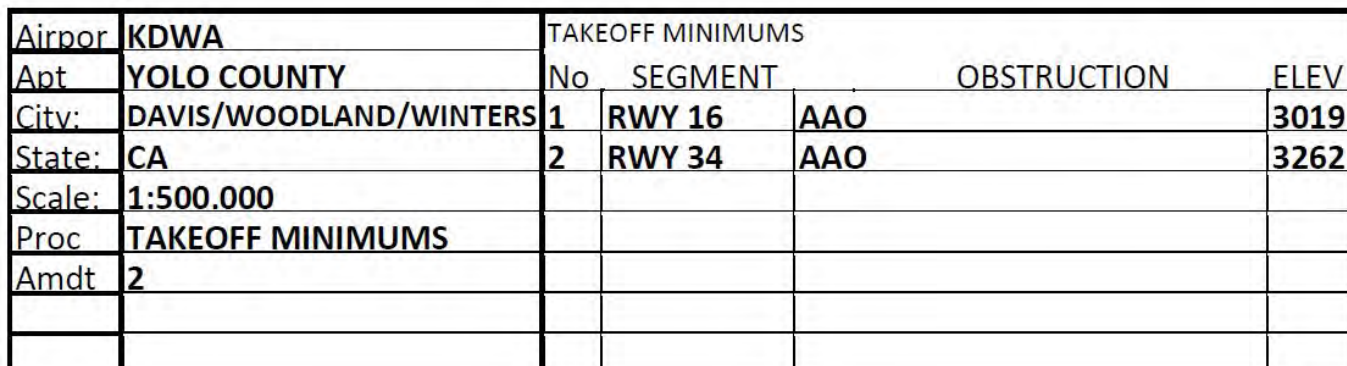

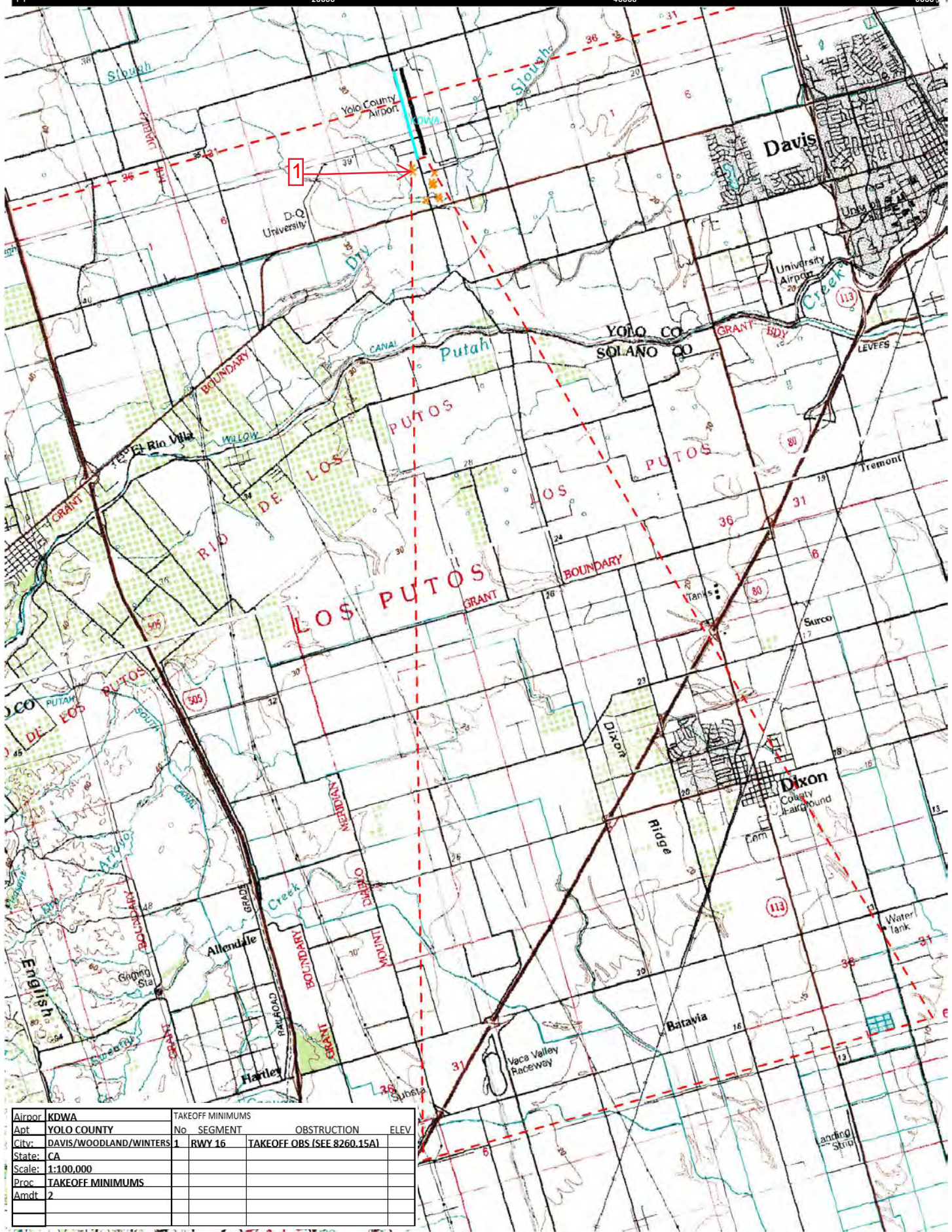

Airport	KDWA	TAKEOFF MINIMUMS			
Apt	YOLO COUNTY	No	SEGMENT	OBSTRUCTION	ELEV
City:	DAVIS/WOODLAND/WINTERS	1	RWY 16	TAKEOFF OBS (SEE 8260.15A)	
State:	CA				
Scale:	1:100,000				
Proc	TAKEOFF MINIMUMS				
Amdt	2				

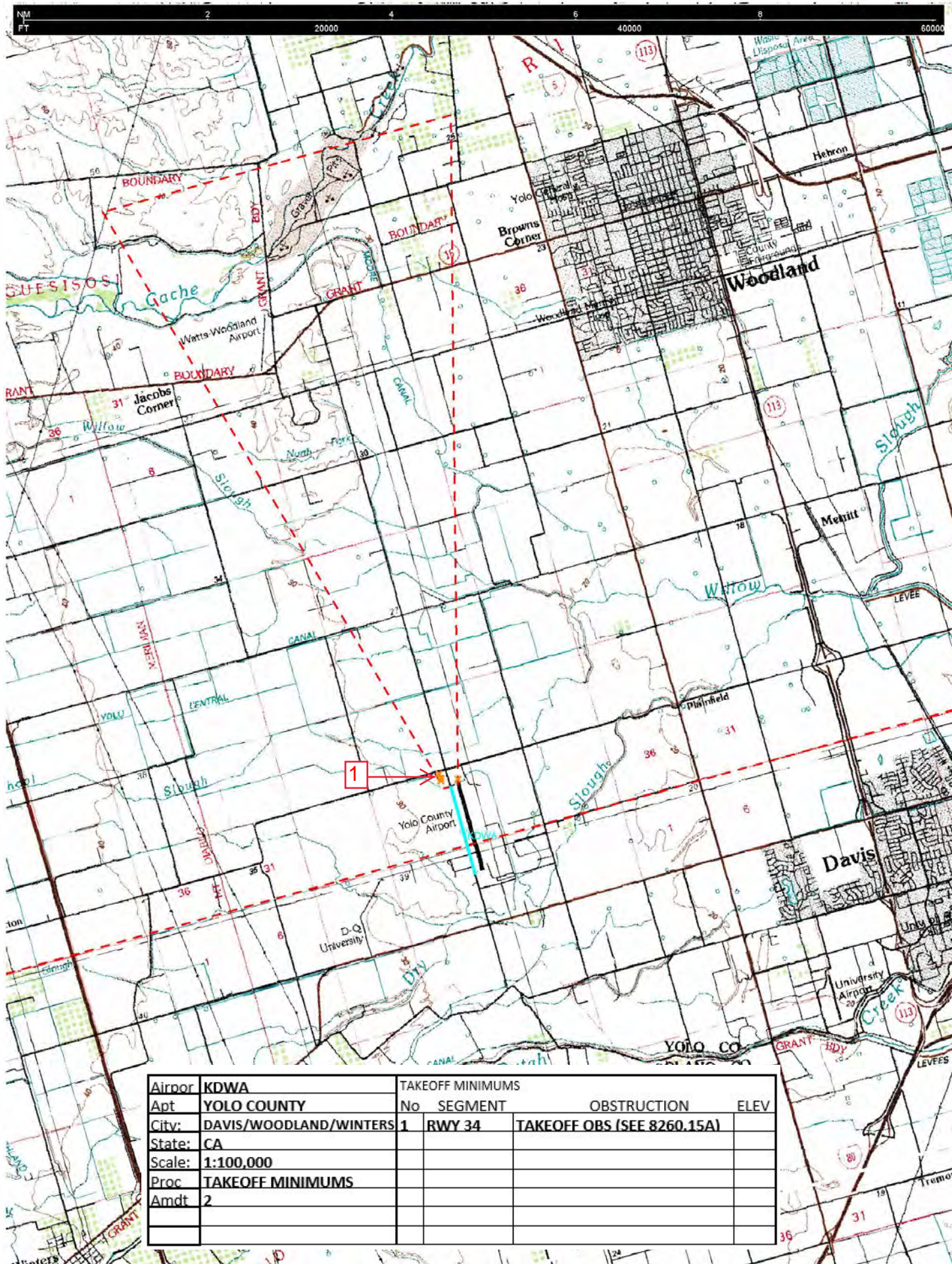

Airpor	KDWA	TAKEOFF MINIMUMS			
Apt	YOLO COUNTY	No	SEGMENT	OBSTRUCTION	ELEV
City:	DAVIS/WOODLAND/WINTERS	1	RWY 34	TAKEOFF OBS (SEE 8260.15A)	
State:	CA				
Scale:	1:100,000				
Proc	TAKEOFF MINIMUMS				
Amdt	2				