

<b>Flight Procedure Tracking Form</b>		<b>Action:</b> FLIGHT CHECK	<b>Task Type:</b> TEXTUAL DP	<b>Date Open:</b> 02/10/2017	<b>Task #:</b> 2017021032164401001	<b>Request #:</b> 20170210321644
<b>Procedure:</b> SANTA TERESA KDNA AMDT OB			<b>Airport ID:</b> KDNA	<b>Airport:</b> DONA ANA COUNTY INTL JETPORT		<b>Reimbursable #:</b> NO
<b>City:</b> SANTA TERESA	<b>ST:</b> NM	<b>GPS #:</b>	<b>Estimated Chart Date:</b> 06/22/2017			<b>FICO #:</b>
<b>Fac ID:</b> N/A		<b>Fac. Type:</b>			<b>Specialist:</b> CARLOS ESCALANTE	
<b>Procedure Review</b>						
	<b>Rec'd</b>	<b>Rel'd</b>	<b>Full Name</b>	<b>Comments</b>		
<b>Lead:</b>	02/10/2017			<div>APPROVED By Steven M Barnett at 6:23 am, Apr 06, 2017</div> <div>QUALITY 23 CHECKED</div>		
<b>QA:</b>						
<b>Liaison:</b>						
<b>Procedure Comments:</b> ENROUTE-NON <b>Remark Type:</b> INFORMATION						
ABBREVIATED AMENDMENT						
ICAO IDENTIFIER CHANGE FROM K5T6 TO KDNA						
REMARKS: REQUEST TABLE TOP ONLY FC EVAL						
FORMS ENCLOSED: 8260-15A						
CONTACT ALLAN WILL (MANAGER) 405-954-6103						

NM 2 4 6 8  
 FT 20000 40000 60000

Airport ID:	KDNA	FM			
Apt Name:	DONA ANA COUNTY INTL JETPORT	No	9	SEGMENT	OBSTRUCTION ELEV
City:	SANTA TERESA			ICA	LOW CLOSE IN
State:	NM				
Scale:	1:100,000				
Proc ID:	DEPARTURE RW10				
Amdt #:	ORIG-B				
	ICA				

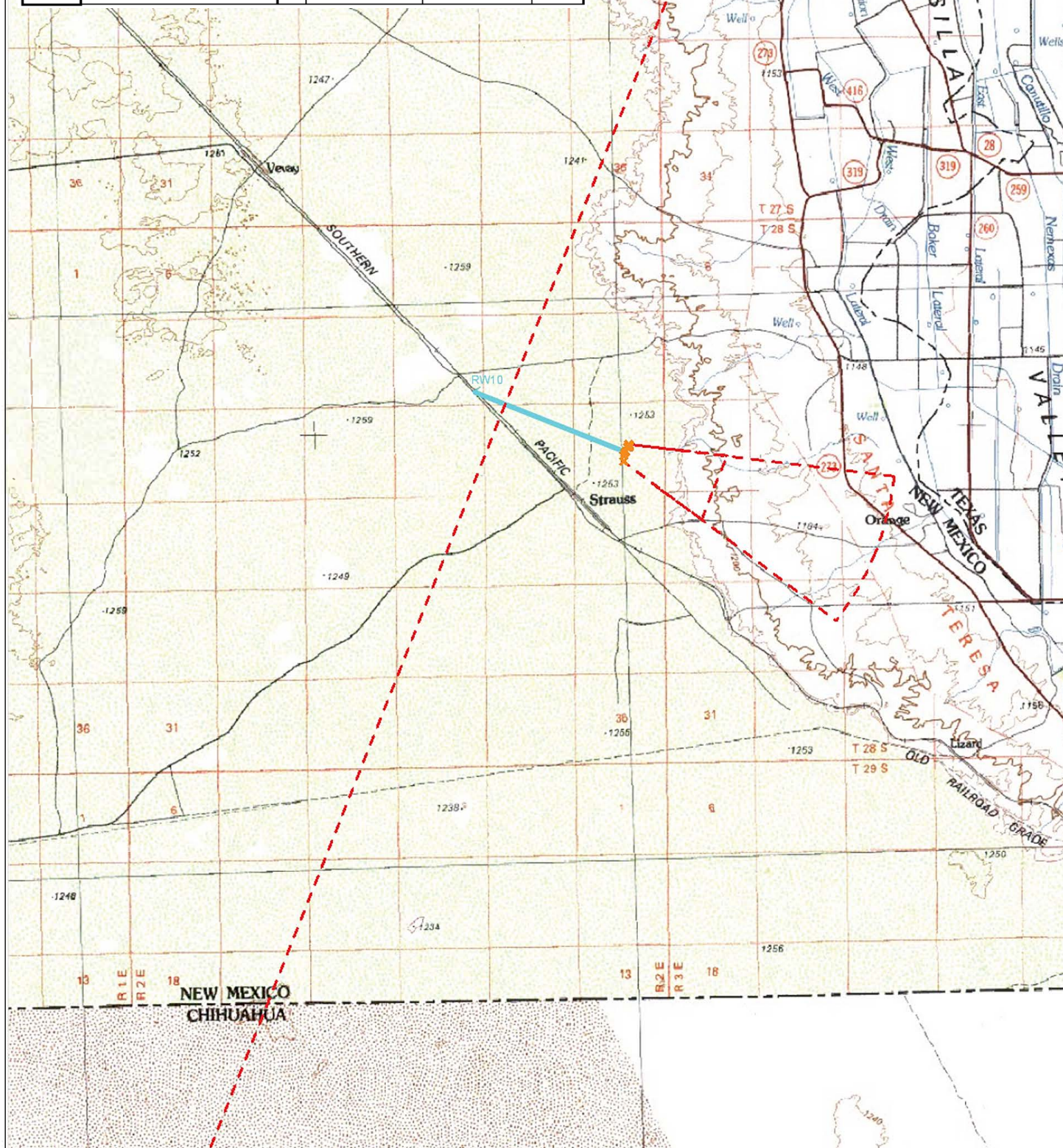

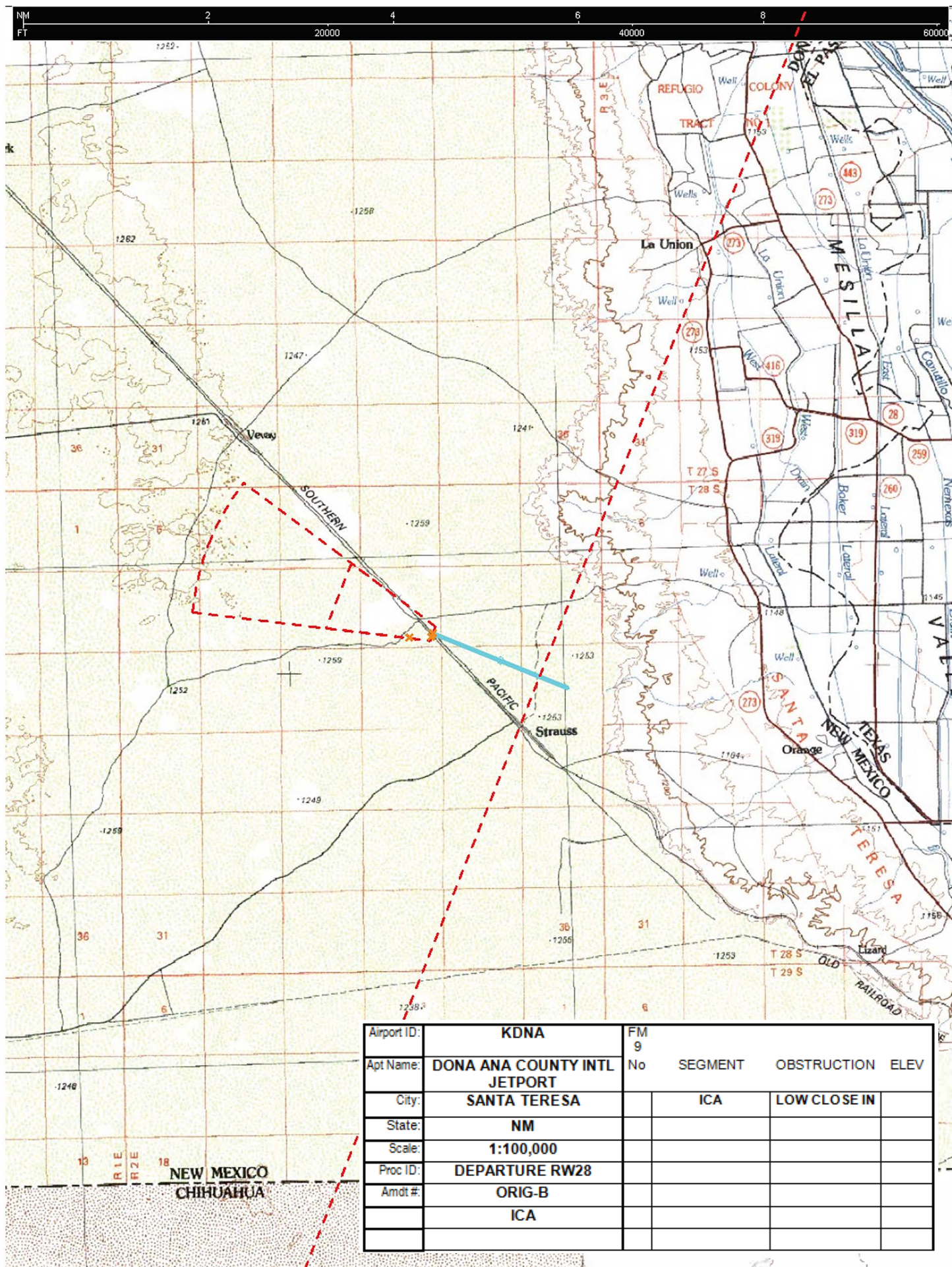

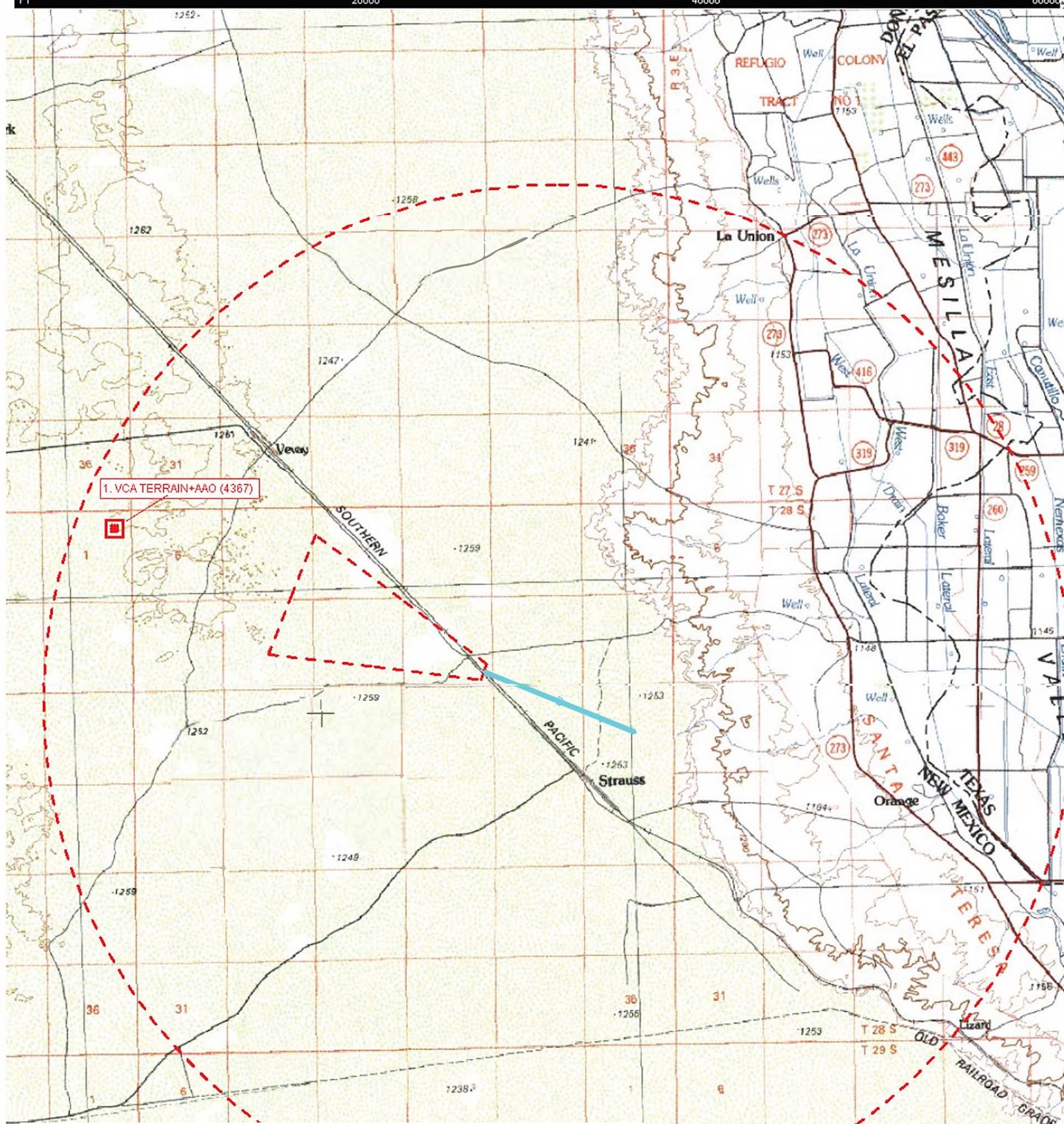

Airport ID:	<b>KDNA</b>	FM			
Apt Name:	<b>DONA ANA COUNTY INTL JETPORT</b>	9			
City:	<b>SANTA TERESA</b>	No	SEGMENT	OBSTRUCTION	ELEV
State:	<b>NM</b>	1	VCOA	TERRAIN+AAO	4367
Scale:	<b>1:100,000</b>				
Proc ID:	<b>DEPARTURE RW28</b>				
Amdt #:	<b>ORIG-B</b>				
	<b>VCOA</b>				

NM 2 4 6 8  
 FT 20000 40000 60000

Airport ID:	KDNA	FM			
Apt Name:	DONA ANA COUNTY INTL JETPORT	No	9	SEGMENT	OBSTRUCTION
City:	SANTA TERESA	1	VCOA	TERRAIN+AAO	ELEV
State:	NM				
Scale:	1:100,000				
Proc ID:	DEPARTURE RW10				
Amdt #:	ORIG-B				
	VCOA				

