

Flight Procedure Tracking Form		Action: FLIGHT CHECK	Task Type: IAP	Date Open: 03/31/2015	Task #: 2014071726505803015	Request #: 20140717265058
Procedure: RADAR AMDT 26			Airport ID: KFWA	Airport: FORT WAYNE INTL	Reimbursable #: NO	
City: FORT WAYNE	ST: IN	GPS #:	Estimated Chart Date: 04/27/2017		FICO #:	
Fac ID: FWA		Fac. Type: ASR		Specialist: PABLO ORTIZ		
Procedure Review						
	Rec'd	Rel'd	Full Name	Comments		
Lead:	04/25/2016	08/24/2016	JACOB POWERS	<div>QUALITY</div> <div>10</div> <div>CHECKED</div>		
QA:	08/24/2016	08/24/2016	JACOB POWERS			
Liaison:	08/24/2016	08/24/2016	MARY MCDONALD			
Procedure Comments:			ENROUTE-NON	Remark Type: INFORMATION		
<p>ASSIGNED MAG/VAR</p> <p>FWA ILS : OLD 3W - NEW 6W</p> <p>HVD ILS: OLD 5W - NEW 6W</p> <p>FWA ASR: OLD 3W - NEW 6W</p> <p>KFWA: OLD 3W - NEW 6W</p> <p>FWA VORTAC: OLD 0E - NEW 6W</p> <p>PENDING DATA USED FOR KFWA AIRPORT AND RUNWAYS</p> <p>PENDING DATA USED FOR FWA ILS, HVD ILS, FWA ASR</p> <p>CONTACT: STEVEN VARGAS, AJV-5421 / PETER GETZ, AJV-5423 / JULIE MORGAN AJV-5422, 405.954.0695/4919/8568</p> <p>01/05/17: THIS IS AN UPDATED COPY OF THE FORM DEVELOPED ON 06/03/16.</p> <p>1. UPDATED RWY 05, 14 AND 23 MISSED APPROACH FROM FWA R-128 TO FWA R-134 AND HOLDING COURSE INBOUND FROM 308.02 TO 314.02.</p> <p>2. UPDATED RWY 23 MISSED APPROACH FROM FWA R-279 TO FWA R-285 AND HOLDING COURSE INBOUND FROM 099.25 TO 105.25.</p>						

fpopxo | fwaars5 (PROD) | 25 Oct 2016 10:50:05 | 1" = 41666.7 feet (MAP)

Airport ID	KFWA	SEGMENT OBSTRUCTION ELEV			
Apt Name:	FORT WAYNE INTL				
City:	FORT WAYNE		FINAL RW05		
State:	IN	5.	MISSED LVL SFC / MISSED HOLDING	TOWER	1223
Proc ID:	RADAR-1				
Amdt #:	26				
Scale:	1:500,000				

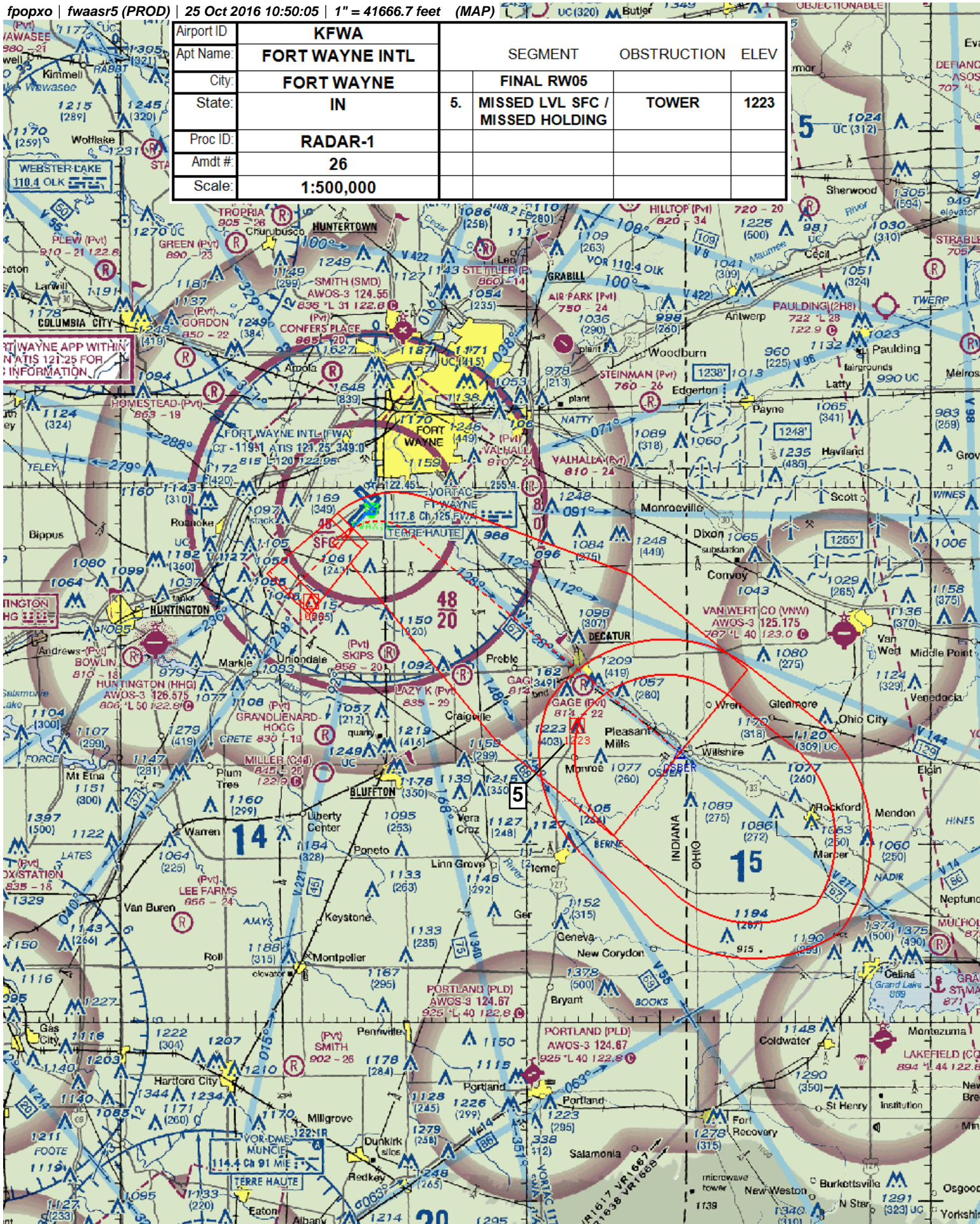

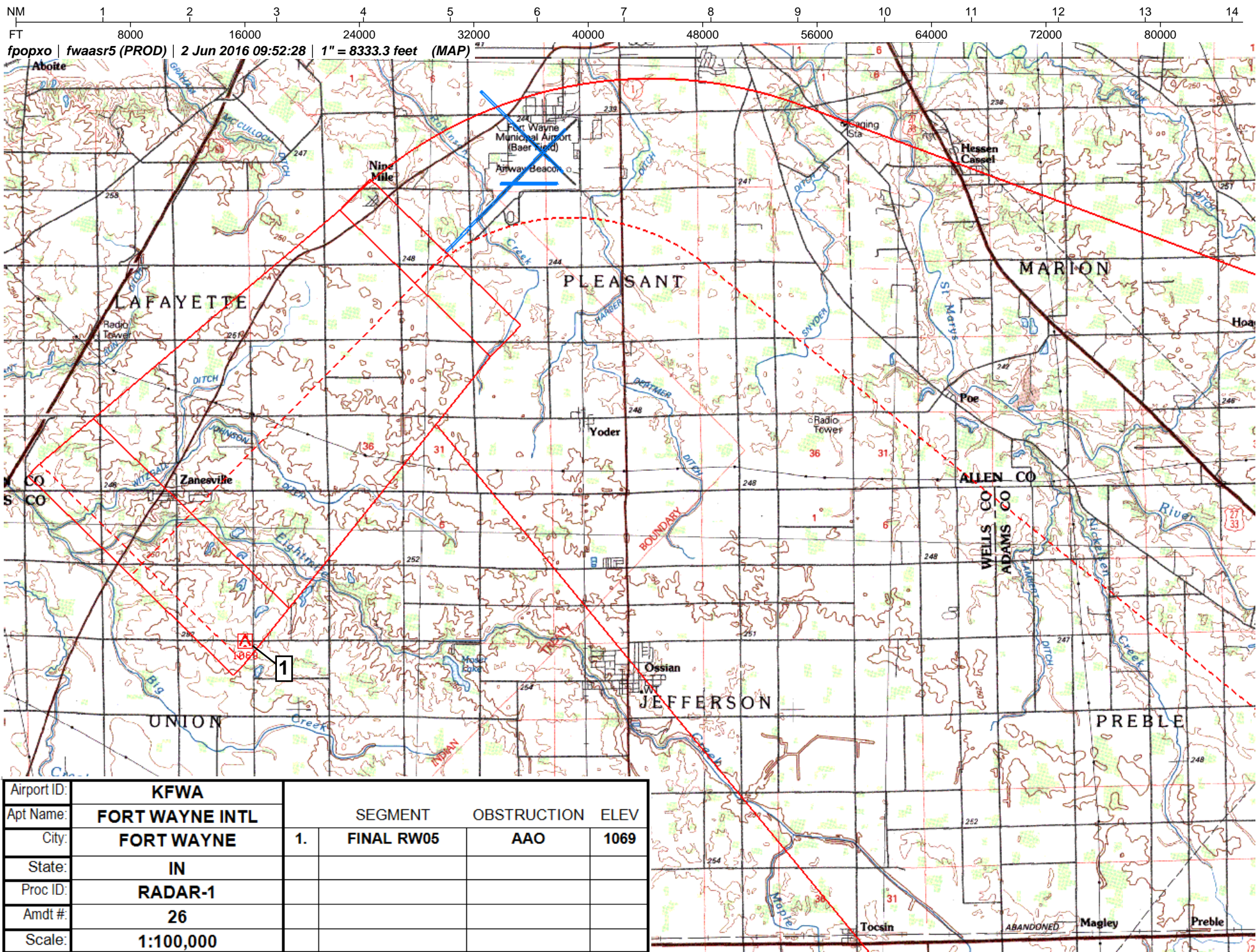

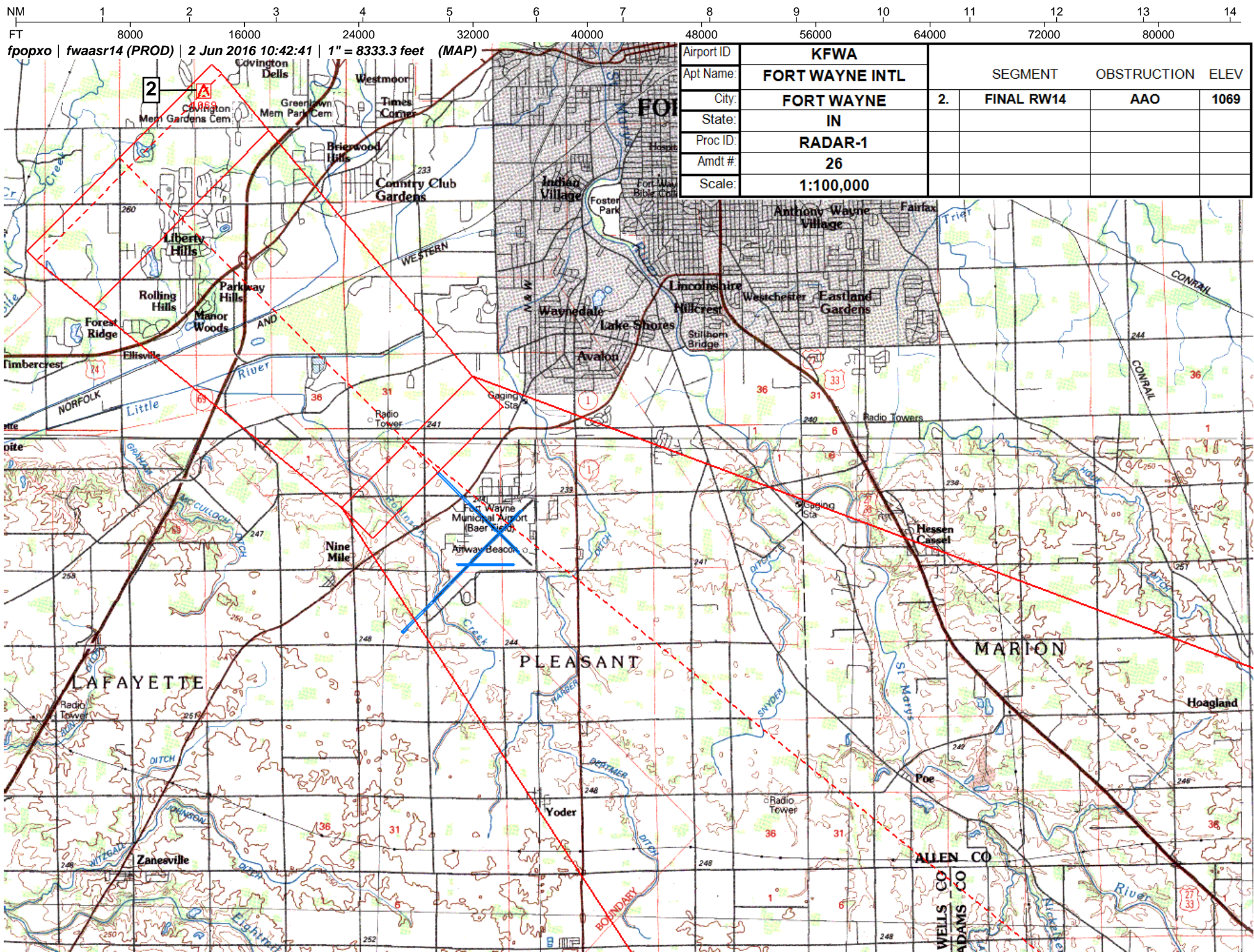

fpopxo | fwaasr23 (PROD) | 25 Oct 2016 10:58:23 | 1" = 41666.7 feet (MAP)

Airport ID	KFWA				
Apt Name:	FORT WAYNE INTL		SEGMENT	OBSTRUCTION	ELEV
City:	FORT WAYNE		FINAL RW23		
State:	IN		5. MISSED LVL SFC / MISSED HOLDING	TOWER	1223
Proc ID:	RADAR-1				
Amdt #:	26				
Scale:	1:500,000				



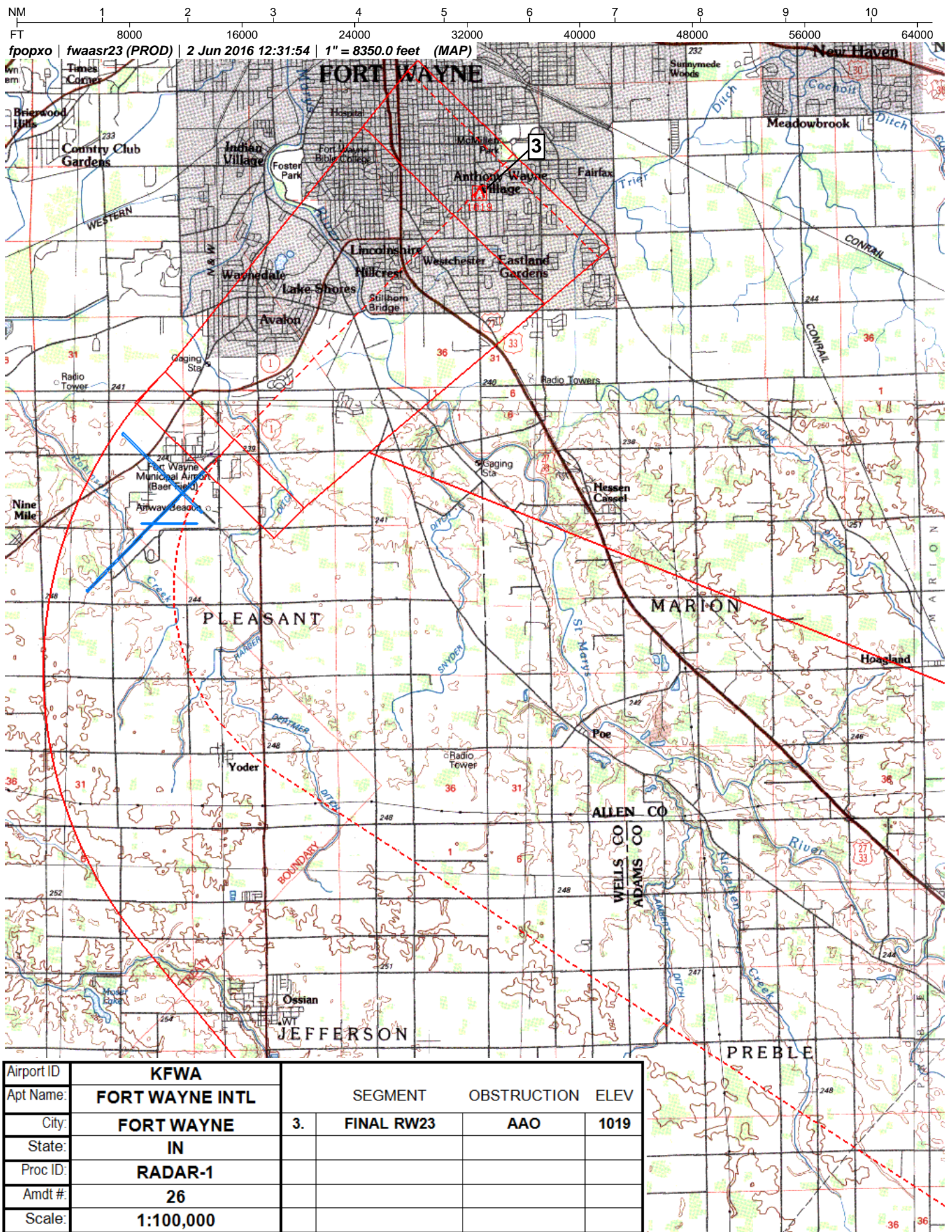

Airport ID	KFWA				
Apt Name:	FORT WAYNE INTL	SEGMENT	OBSTRUCTION	ELEV	
City:	FORT WAYNE	3.	FINAL RW23	AAO	1019
State:	IN				
Proc ID:	RADAR-1				
Amdt #:	26				
Scale:	1:100,000				

Airport ID	KFWA				
Apt Name:	FORT WAYNE INTL		SEGMENT	OBSTRUCTION	ELEV
City:	FORT WAYNE		FINAL RW32		
State:	IN		7. MISSED LVL SFC	TOWER	1172
Proc ID:	RADAR-1		H. MISSED HOLDING	TOWER	1199
Amdt #:	26				
Scale:	1:500,000				

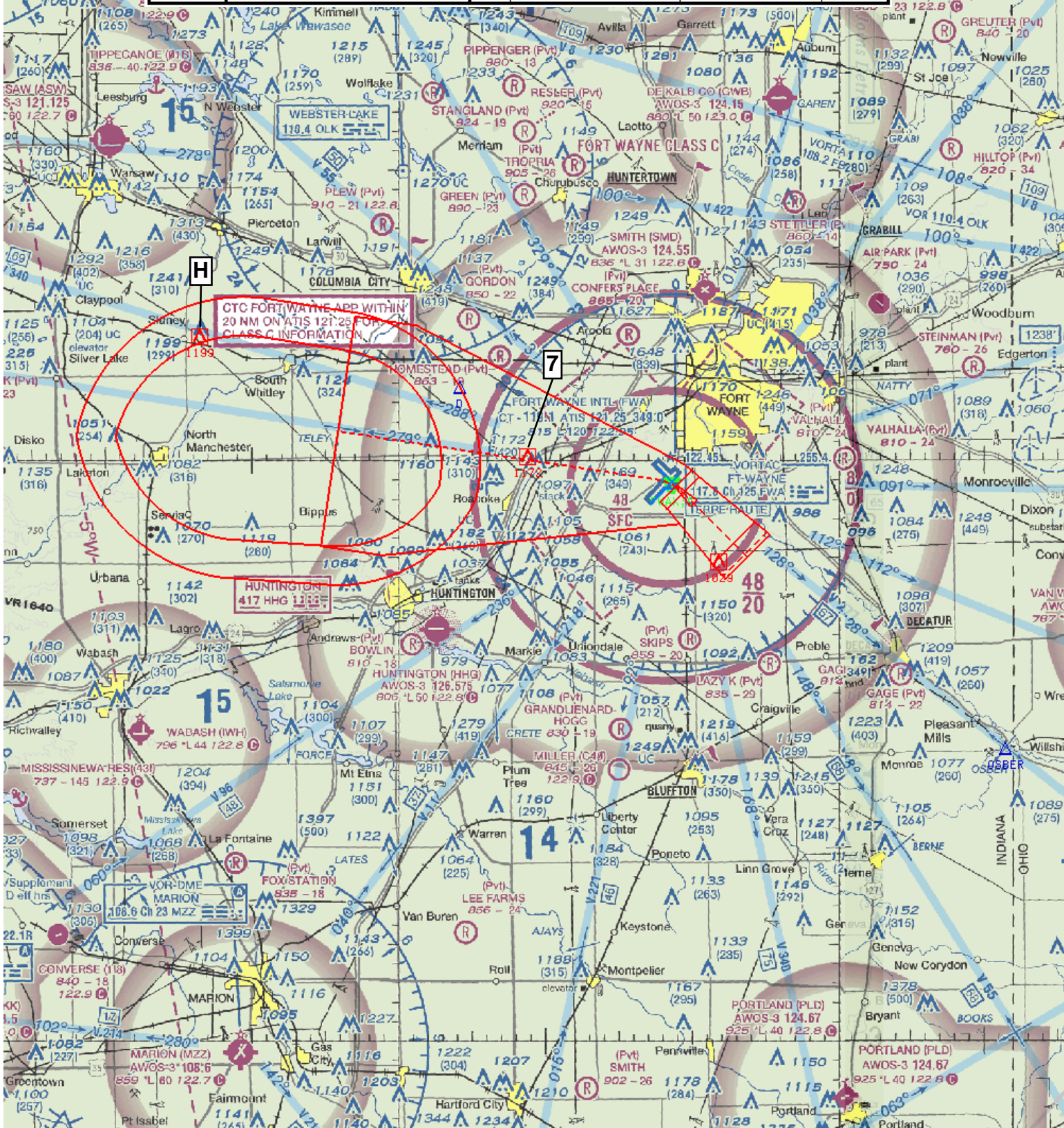

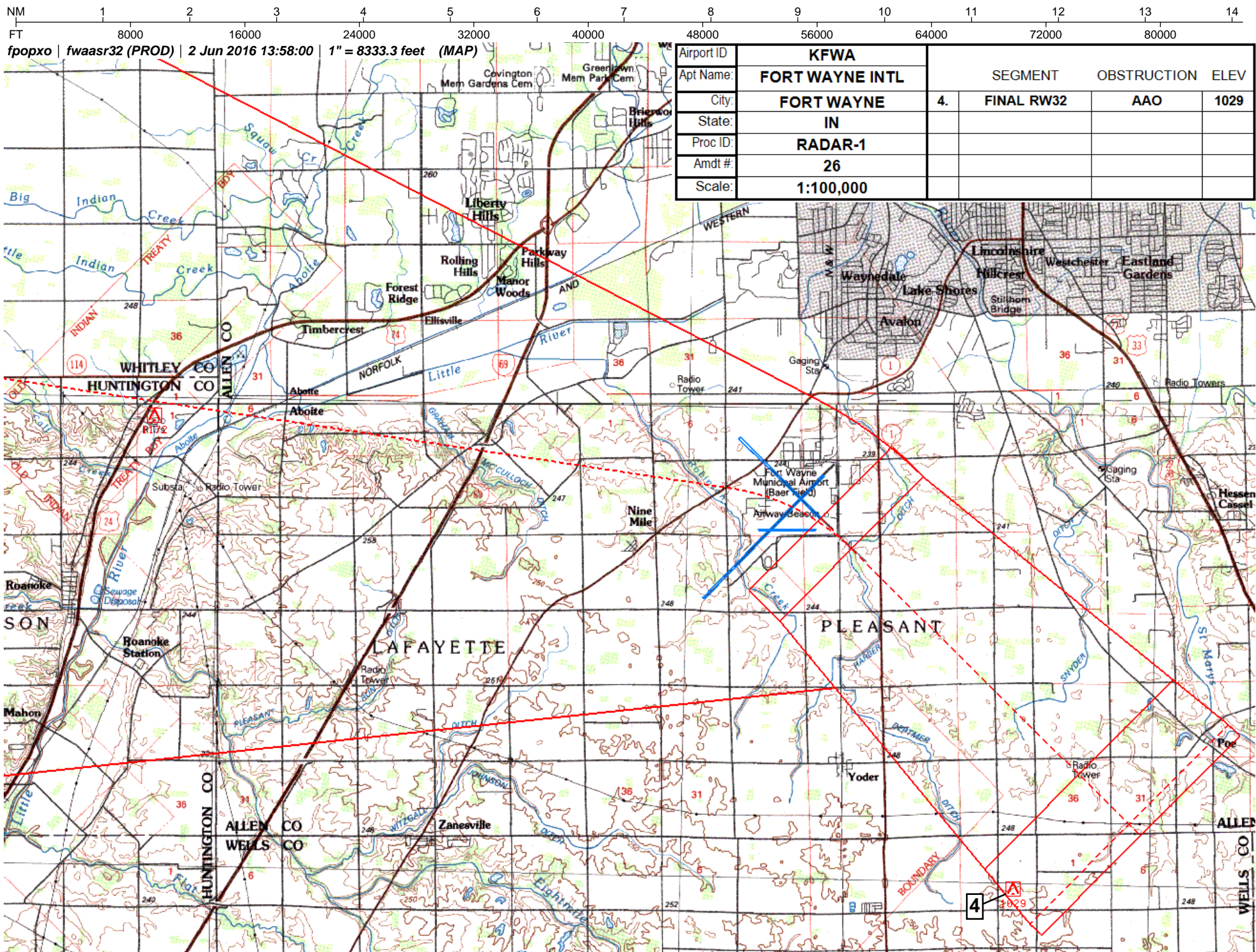

NM 1 2 3 4 5 6 7 8 9 10
FT 8000 16000 24000 32000 40000 48000 56000 64000

fpopxo | fwaasrcirc (PROD) | 3 Jun 2016 10:45:22 | 1" = 8333.3 feet (MAP)

Airport ID	KFWA			
Apt Name:	FORT WAYNE INTL		SEGMENT	OBSTRUCTION ELEV
City:	FORT WAYNE		9. CIRC CAT A/B	ATCT 1000
State:	IN		10. CIRC CAT C	TOWER 1061
Proc ID:	RADAR-1		11. CIRC CAT D/E	TOWER 1169
Amdt #:	26			
Scale:	1:100,000			

