

<b>Flight Procedure Tracking Form</b>		<b>Action:</b> FLIGHT CHECK	<b>Task Type:</b> IAP	<b>Date Open:</b> 07/29/2014	<b>Task #:</b> 2014042915115201002	<b>Request #:</b> 20140429151152
<b>Procedure:</b> RNAV (GPS) RWY 4 ORIG			<b>Airport ID:</b> KIXD	<b>Airport:</b> NEW CENTURY AIRCENTER		<b>Reimbursable #:</b> NO
<b>City:</b> OLATHE	<b>ST:</b> KS	<b>GPS #:</b>	<b>Estimated Chart Date:</b> 09/15/2016		<b>FICO #:</b>	
<b>Fac ID:</b> N/A		<b>Fac. Type:</b>		<b>Specialist:</b> JOHN HAZELTON		
<b>Procedure Review</b>						
	<b>Rec'd</b>	<b>Rel'd</b>	<b>Full Name</b>	<b>Comments</b>		
<b>Lead:</b>	11/05/2014	04/06/2016	THOMAS KIRKPATRICK			
<b>QA:</b>	04/06/2016					
<b>Liaison:</b>						
<b>Procedure Comments:</b>			<b>Remark Type:</b> INFORMATION			
KIXD NEW CENTURY AIRCENTER RNAV (GPS) RWY 4 ORIG  PENDING DATA USED FOR KIXD AIRPORT AND RUNWAYS CONTACT: JACOB POWERS/TOM KIRKPATRICK AJV-542 POC, 405.8702/8393						

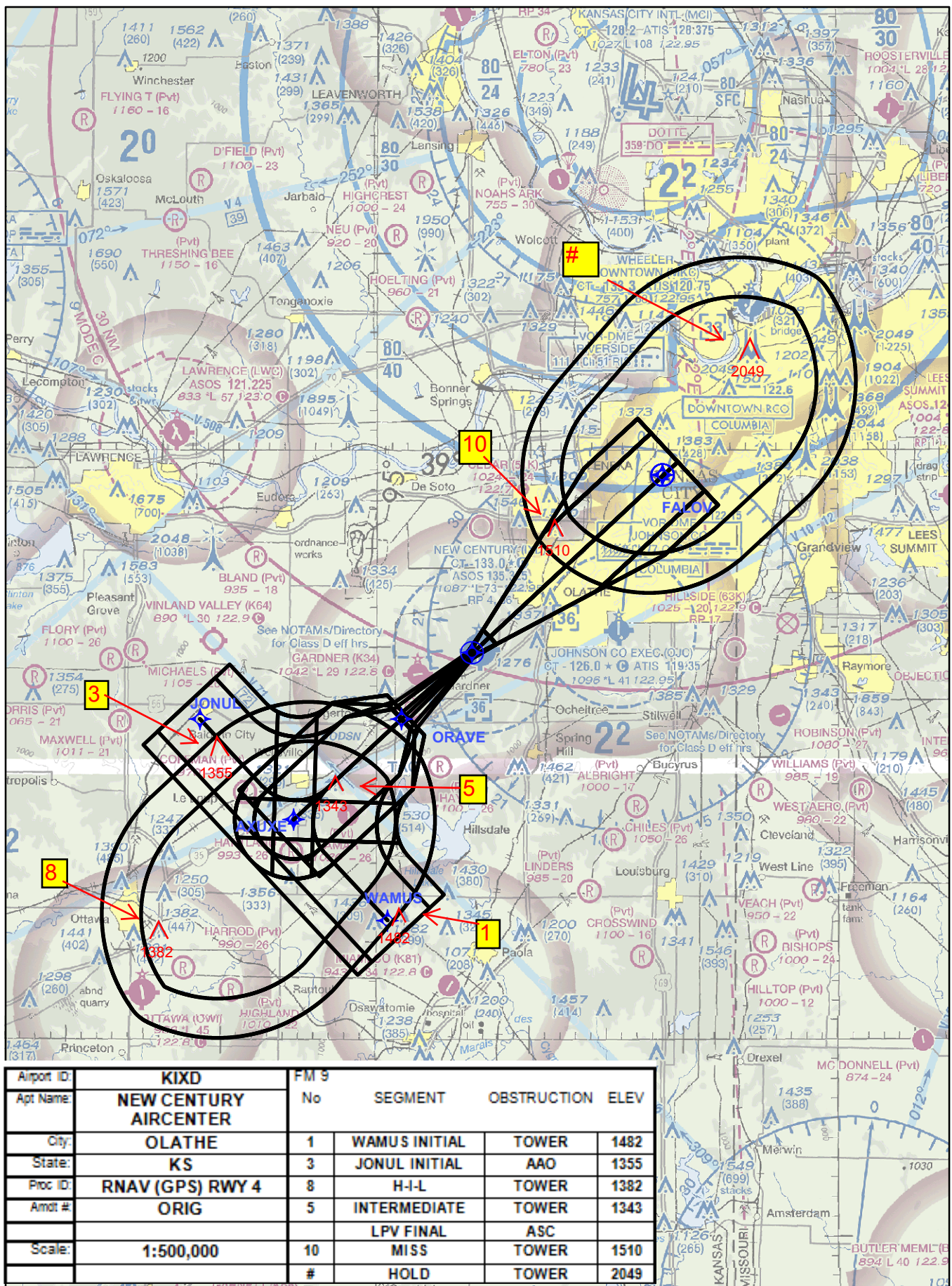

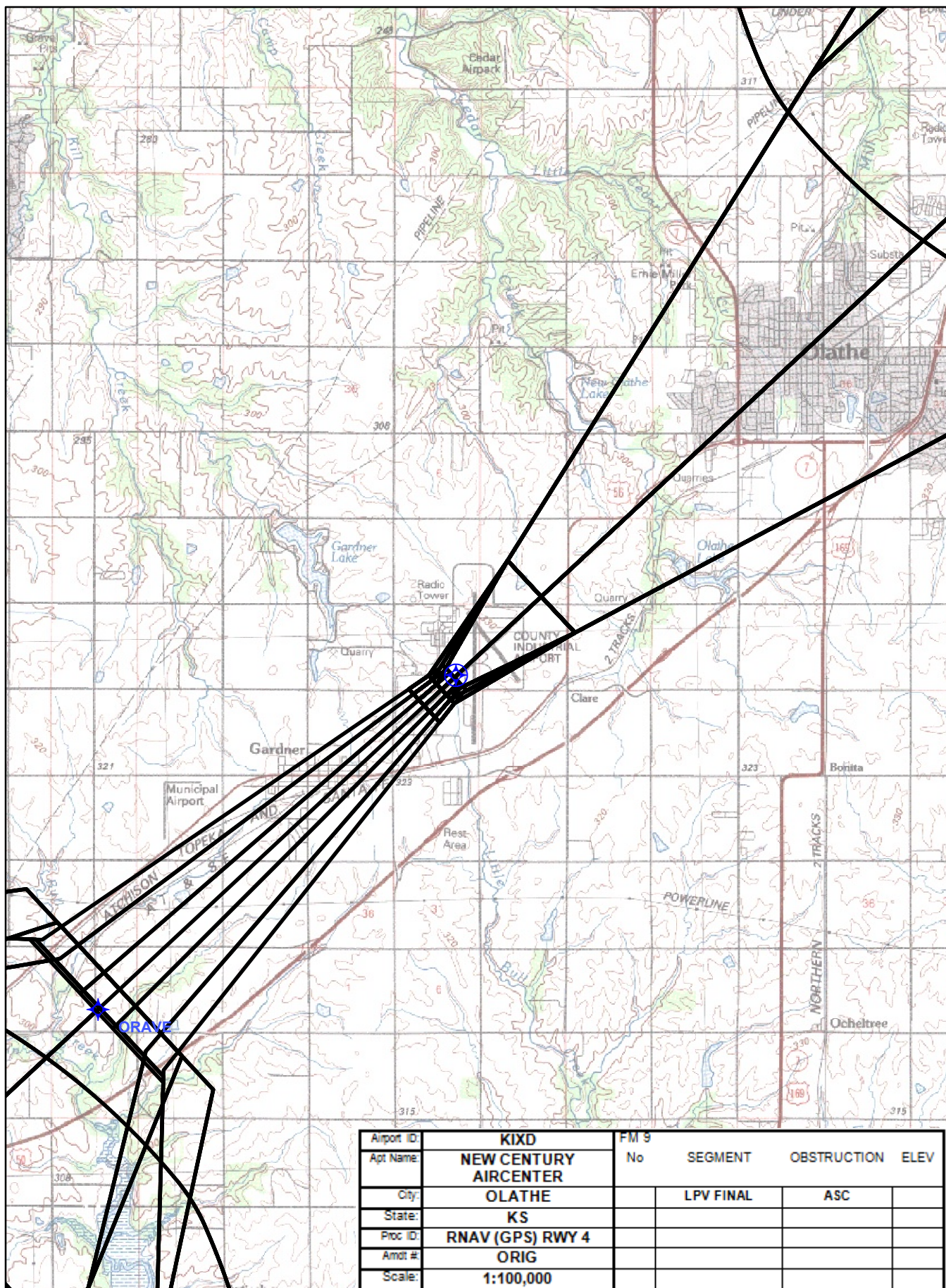







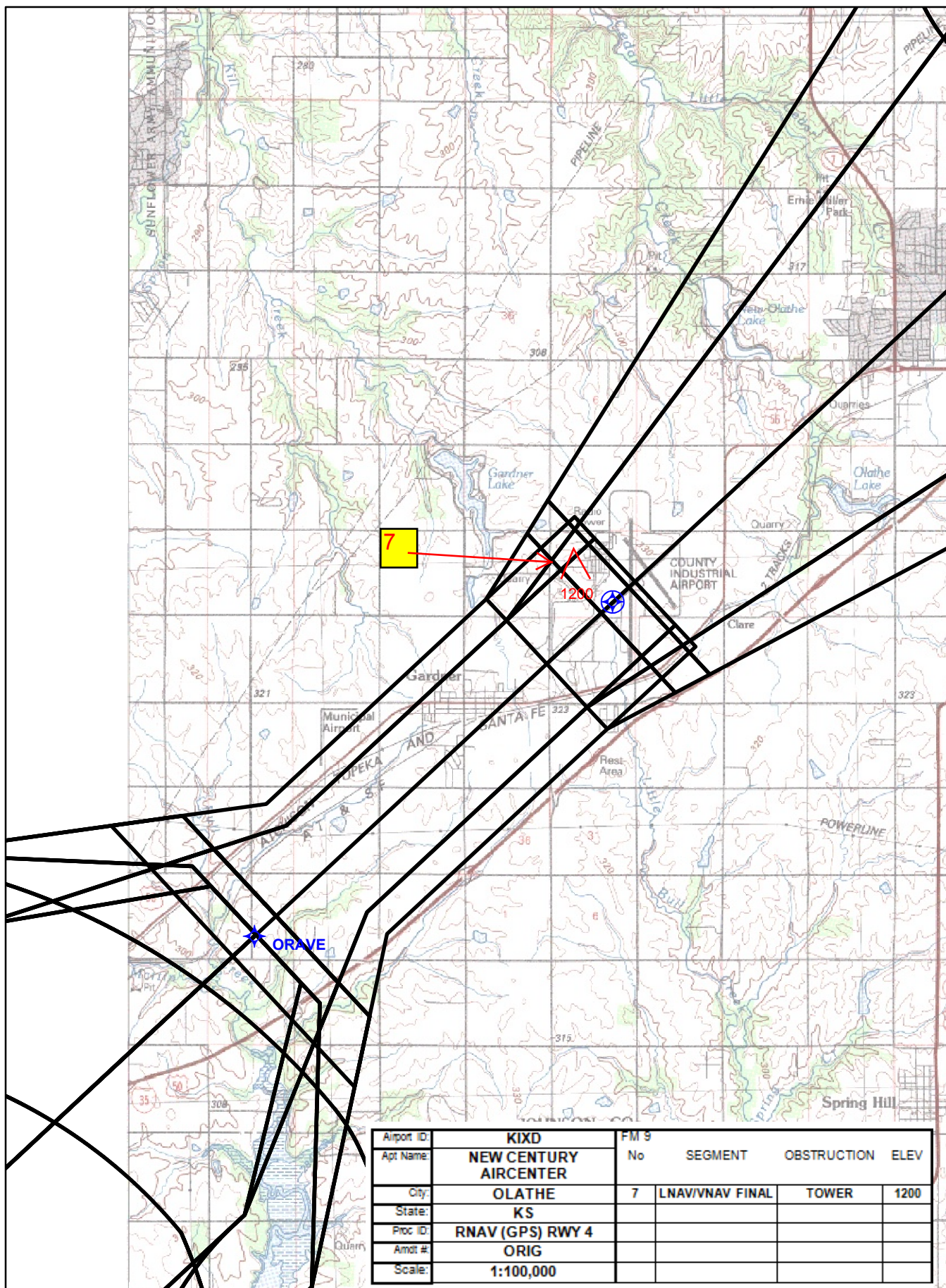



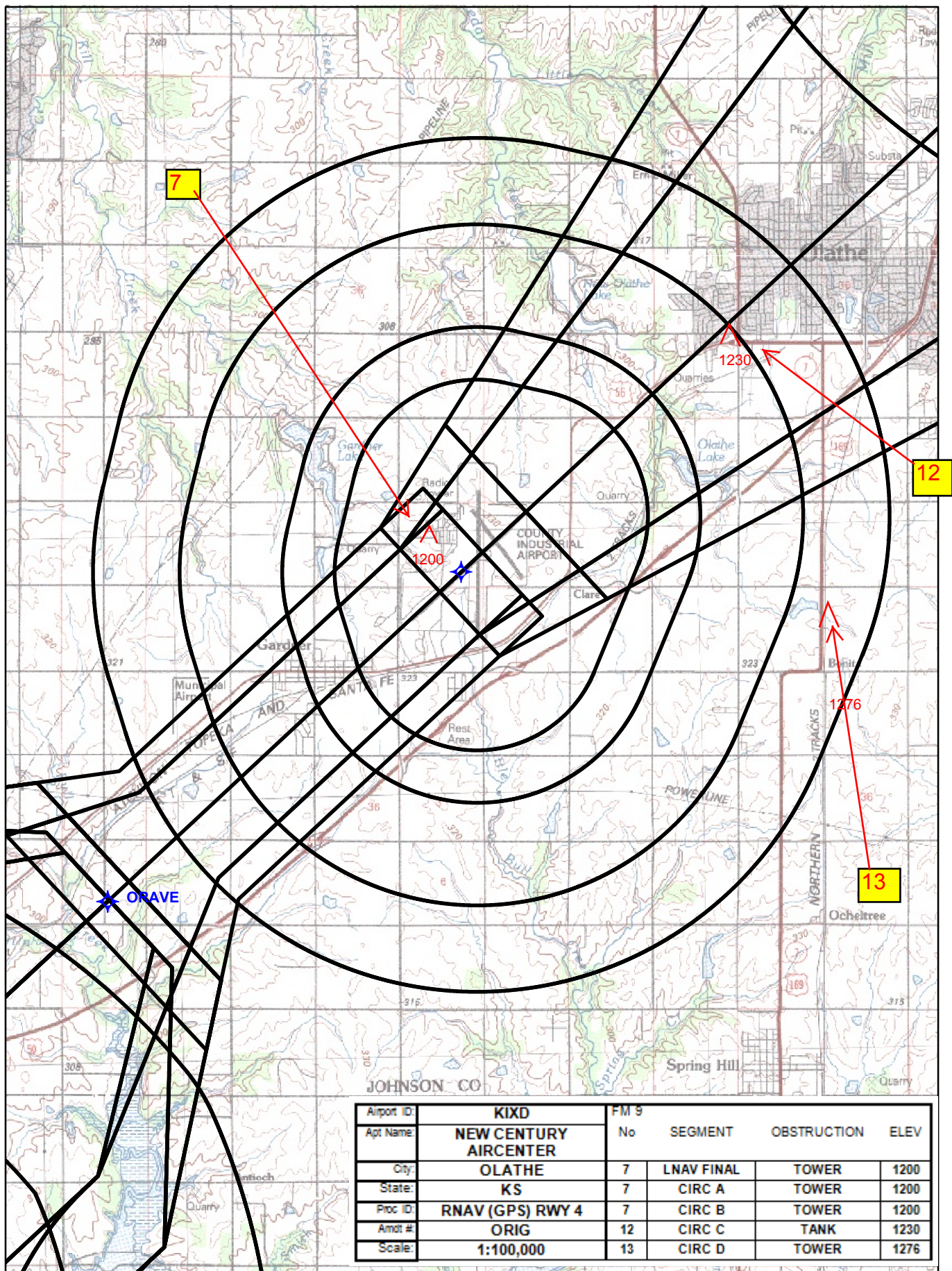



# TERMINAL AIRSPACE DATA REQUIREMENTS

CITY: OLATHE

STATE: KS

AIRPORT NAME: NEW CENTURY AIRCENTER

ID:

PROCEDURE: RNAV (GPS) RWY 4

AMDT: ORIG

DOCKET # :

(96-AXX-X/Required/Not Required)

**ALL DIST TO 1/100 NM; ELEV TO NEAREST FT; COORD TO 1/100 SEC; DEG TO 1/100 DG.**

- |   |            |                                |             |
|---|------------|--------------------------------|-------------|
| 1. Distance from  | THLD       | to 1000' point                 | 3.34        |
| <small>(Enter THLD, FAF, ARP, FACILITY, as appropriate)</small>                           |            |                                |             |
| 2. Width of   | FINAL      | segment at 1000' point         | 1.20        |
| <small>(Enter appropriate segment , final, intermediate, etc.)</small>                    |            |                                |             |
| 3. True Course of   | FINAL      | segment containing 1000' point | 47.03       |
| 4. High Terrain in  | FINAL      | segment containing 1000' point | 1120        |
| 5. Distance from  | THLD       | to 1500' point                 | 4.97        |
| <small>(If 1500' point in PT maneuvering area or holding pattern note in remarks)</small> |            |                                |             |
| 6. Width of   | FINAL      | segment at 1500' point         | 2.13        |
| 7. True Course of   | FINAL      | segment containing 1500' point | 47.03       |
| 8. High Terrain in  | FINAL      | segment containing 1500' point | 1120        |
| 9. Threshold Coordinates (if straight-in) ...   | 384941.55N | /                              | 0945342.23W |
| 10. ARP Coordinates .....   | 384951.30N | /                              | 0945325.10W |
| 11. Runway Approach End and distance furthest from ARP.....RWY                            |            |                                | 36          |
|   |            | Distance                       | .70 NM      |
| 12. FAF Coordinates .....   | 384616.08N | /                              | 0945823.86W |
| <small>(Click to Select)</small>  |            |                                |             |

**REMARKS:**