

<b>Flight Procedure Tracking Form</b>		<b>Action:</b> FLIGHT CHECK	<b>Task Type:</b> TEXTUAL DP	<b>Date Open:</b> 12/18/2015	<b>Task #:</b> 2014031230185402001	<b>Request #:</b> 20140312301854
<b>Procedure:</b> BEACH ND K20U ORIG				<b>Airport ID:</b> K20U	<b>Airport:</b> BEACH	<b>Reimbursable #:</b> NO
<b>City:</b> BEACH	<b>ST:</b> ND	<b>GPS #:</b>	<b>Estimated Chart Date:</b> 05/26/2016		<b>FICO #:</b>	
<b>Fac ID:</b> N/A		<b>Fac. Type:</b>			<b>Specialist:</b> STEVE NELSON	
<b>Procedure Review</b>						
	<b>Rec'd</b>	<b>Rel'd</b>	<b>Full Name</b>	<b>Comments</b>		
<b>Lead:</b>	12/21/2015					
<b>QA:</b>						
<b>Liaison:</b>						
<b>Procedure Comments:</b>			ENROUTE-NON	<b>Remark Type:</b> INFORMATION		
ASSIGNED MAG VAR, K20U: OLD 12E-NEW 8E. CONTACT: JACOB POWERS, AJV-542 SUBTEAM MANAGER, 405.954.8702.						

NM 7 14 21 28 35 42 49  
FT 42000 84000 126000 168000 210000 252000 294000

fpospn | k20uodp12 (PROD) | 23 Dec 2015 09:32:10 | 1" = 41666.7 feet (MAP)

Airport ID K20U  
Apt Name BEACH  
City BEACH  
State ND  
Proc ID ODP - TAKEOFF RWY 12  
Amdt ORIG  
Scale 1:500,000

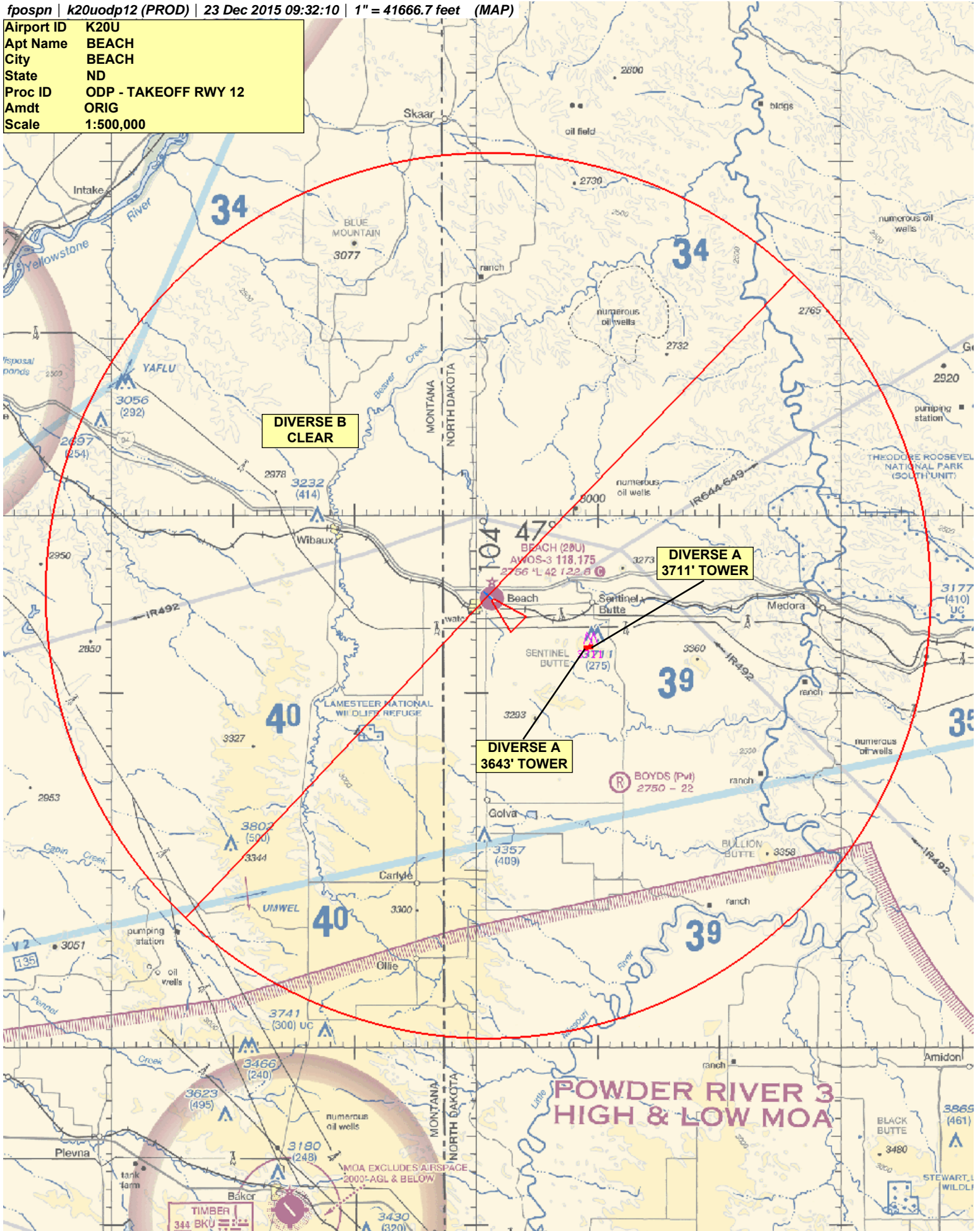



NM 1 2 3 4 5 6 7 8 9 10  
FT 8000 16000 24000 32000 40000 48000 56000 64000

fpospn | k20uodp12 (PROD) | 25 Jan 2016 12:08:08 | 1" = 8333.3 feet (MAP)

Airport ID K20U  
Apt Name BEACH  
City BEACH  
State ND  
Proc ID ODP - TAKEOFF RWY 12  
Amdt ORIG  
Scale 1:100,000

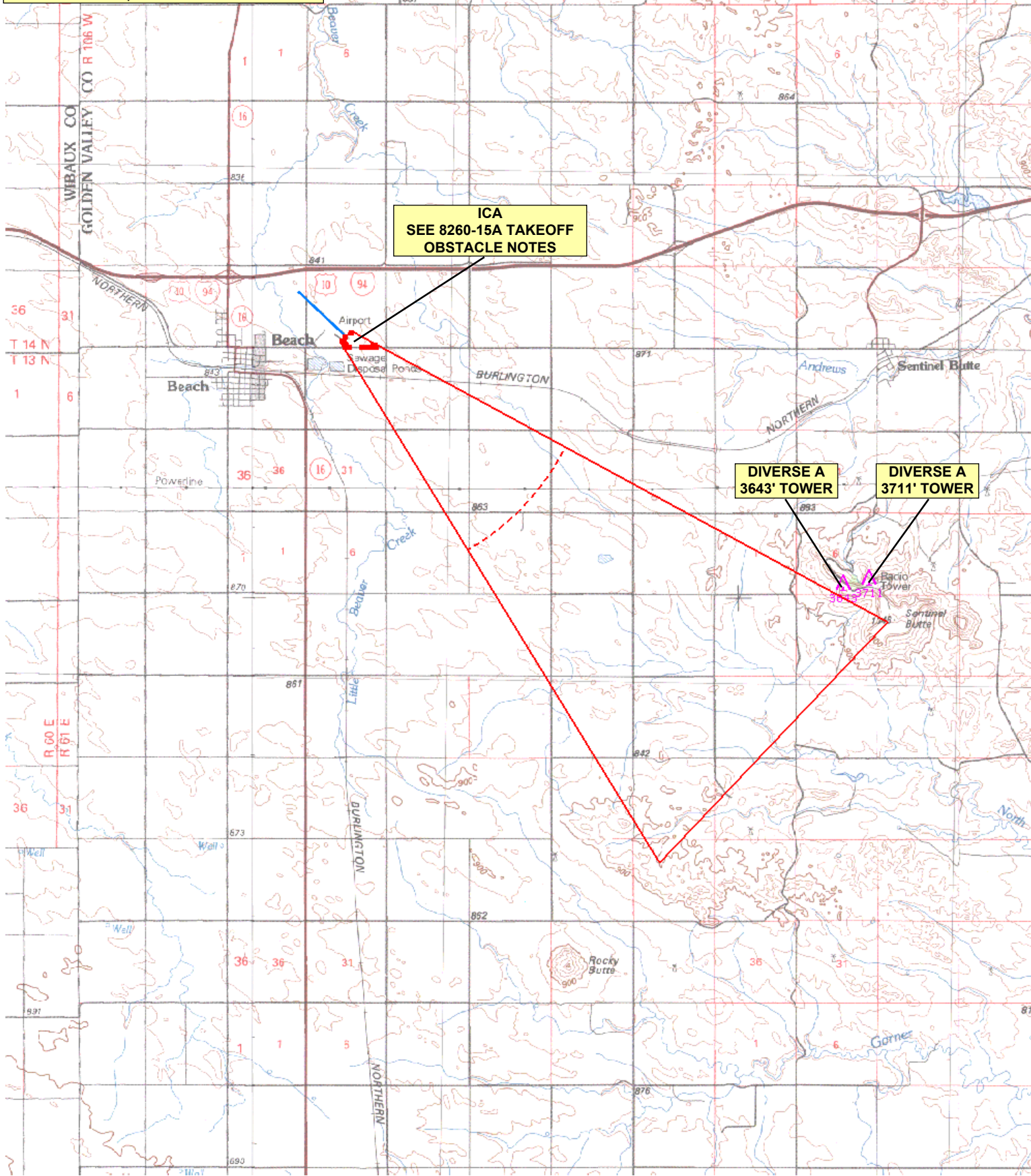



NM 7 14 21 28 35 42 49  
FT 42000 84000 126000 168000 210000 252000 294000

fpospn | k20uodp30 (PROD) | 23 Dec 2015 09:54:16 | 1" = 41666.7 feet (MAP)

Airport ID K20U  
Apt Name BEACH  
City BEACH  
State ND  
Proc ID ODP - TAKEOFF RWY 30  
Amdt ORIG  
Scale 1:500,000

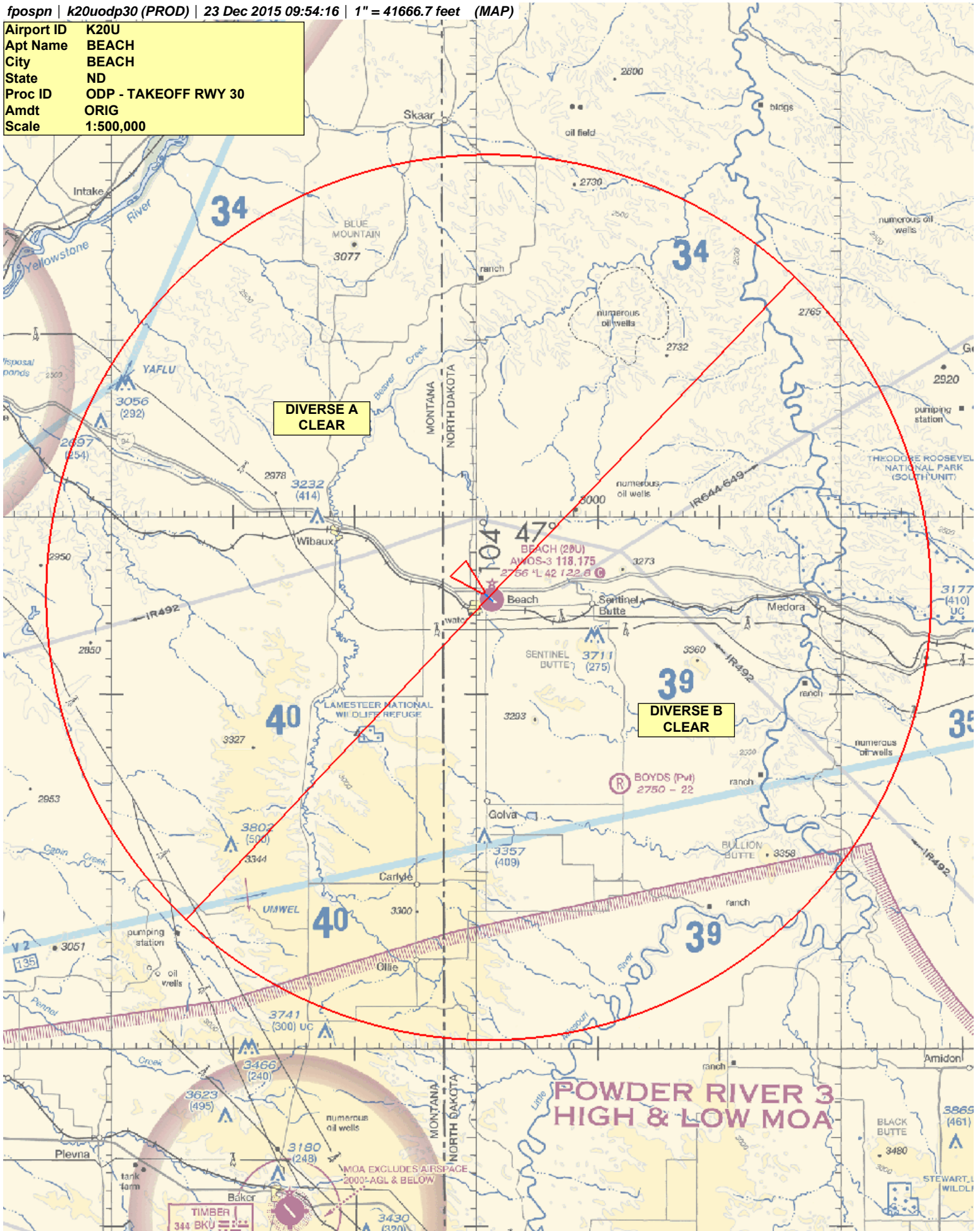

NM 1 2 3 4 5 6 7 8 9 10  
FT 8000 16000 24000 32000 40000 48000 56000 64000

fpospn | k20uodp30 (PROD) | 23 Dec 2015 10:08:39 | 1" = 8333.3 feet (MAP)

Airport ID K20U  
Apt Name BEACH  
City BEACH  
State ND  
Proc ID ODP - TAKEOFF RWY 30  
Amdt ORIG  
Scale 1:100,000

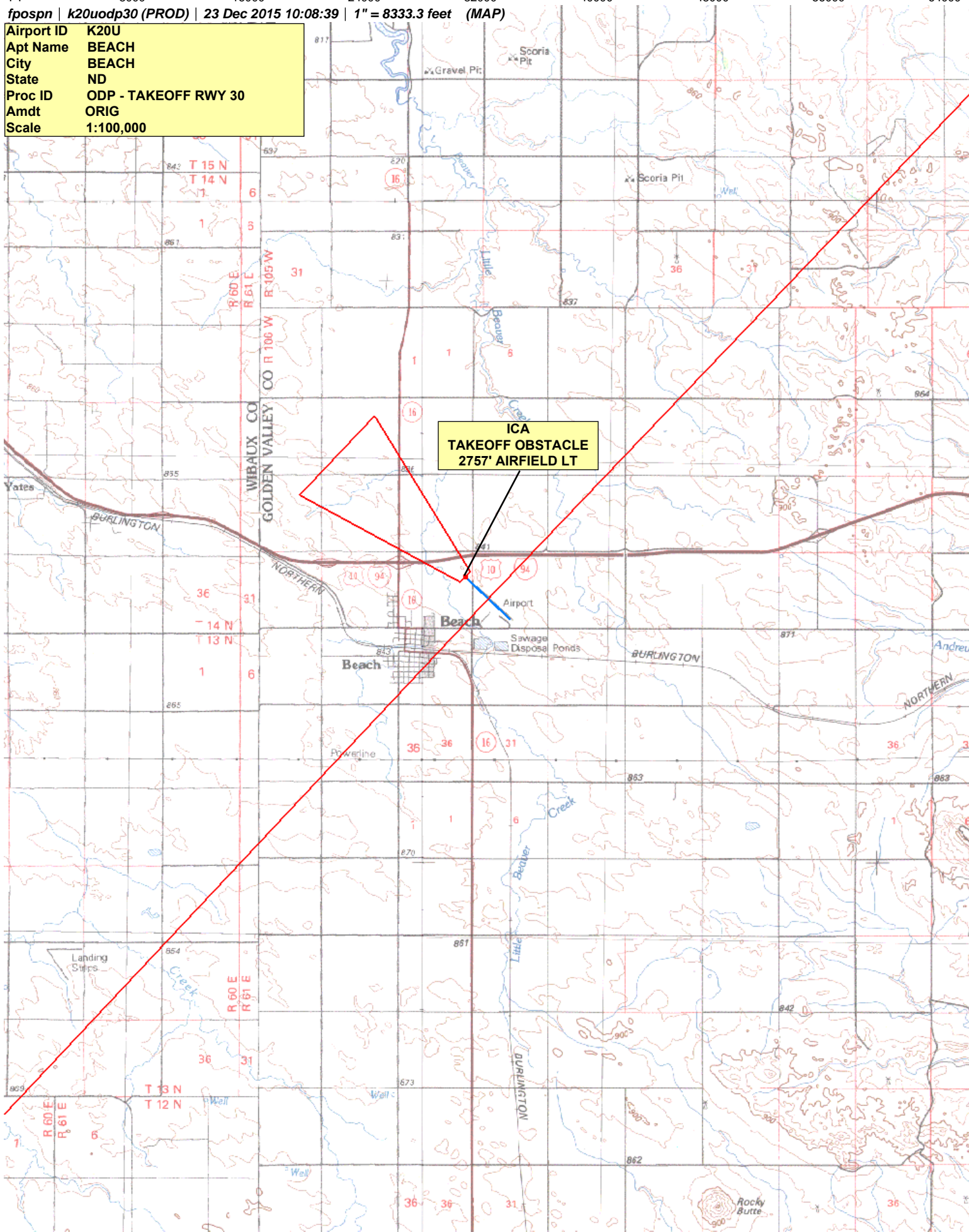





# Federal Aviation Administration

## Initial Development Notification for AIRNAV Pending Records

To: Janet Myers, National Flight Data Center, Sub Team B, AJV-5332

From: Jose Alfonso, Manager IFP Coordination Team, AJV-531

Subject: **ACTION:** Request for Pending Records **K20U\_20U\_\_BEACH, BEACH, ND US**

The Magnetic Variation (MV) data for the airport(s) and/or facility(s) listed will be revised effective concurrent with the publication of the procedure(s) listed below. Estimated Chart Date: 5/26/2016

Old Magnetic Variance (MV) E 12 1985 New MV E 8 2020

ECD	Airport ID		Procedure Name	AMDT #	Task Report Type Selections
5/26/2016	K20U	20U	BEACH ND K20U ORIG	/A	ENROUTE-NON, MAGVAR
5/26/2016	K20U	20U	RNAV (GPS) RWY 12 ORIG	/A	ENROUTE-NON, MAGVAR, NAPT, WAAS
5/26/2016	K20U	20U	RNAV (GPS) RWY 30 ORIG	/A	ENROUTE-NON, MAGVAR, NAPT, WAAS

Airport undergoing VFR to IFR conversion. Mag Var submitted as new assignment vs change per FPT. Airport will not be updating runway numbering at this time.

IF you have any questions please notify: [george.gonzalez@faa.gov](mailto:george.gonzalez@faa.gov)

(405) 954-2884